

Nickey B. Maxey
Colton B. Maxey
50 Rose Dhu Creek Plantation
Bluffton, SC 29910
nmaxey@scdnr.net
843.247.0001



November 12, 2015

REF: 2275S5306038 Removed Crossing,
Closest Crossing to E. is 634867v located S.454.16

CSX Transportation Inc.
Attn: Private Grade Crossing, J-180
6737 Southpoint Drive South
Jacksonville, FL 32216
Customerrel@CSX.com
904-245-4515 fax

Gentlemen:

For more than fifteen years, I have been the owner of property with access to public highway 321 in Scotia, SC by way of an easement and Grade Crossing located as specified above and further referenced by your number 2275S5306038. My predecessor in title informs me that long before he owned the property, the grade crossing existed and was serviced and maintained by your railroad. My property is now LAND LOCKED and I am unable to legally access it by motor vehicle for its beneficial use.

I am not making application for a new grade crossing; I am demanding the replacement of what was improperly removed. Further action in this regard awaits the promptness of your reply.

Very Truly Yours,

Nickey B. Maxey, as parent and attorney in fact for Colton B. Maxey a minor

CC:

Governor Nikki Haley 1205 Pendleton Street Columbia, SC 29201 Attn:Katherine Veldran Deputy Chief of Staff
Director of Transportation, Christy Hall 955 Park Street Columbia, SC 29201✓

Picture #1

Taken From Hwy 321
Estill, SC looking
across the Railroad
onto my Easement.
11-14-15

Hy Moley

Picture

#1

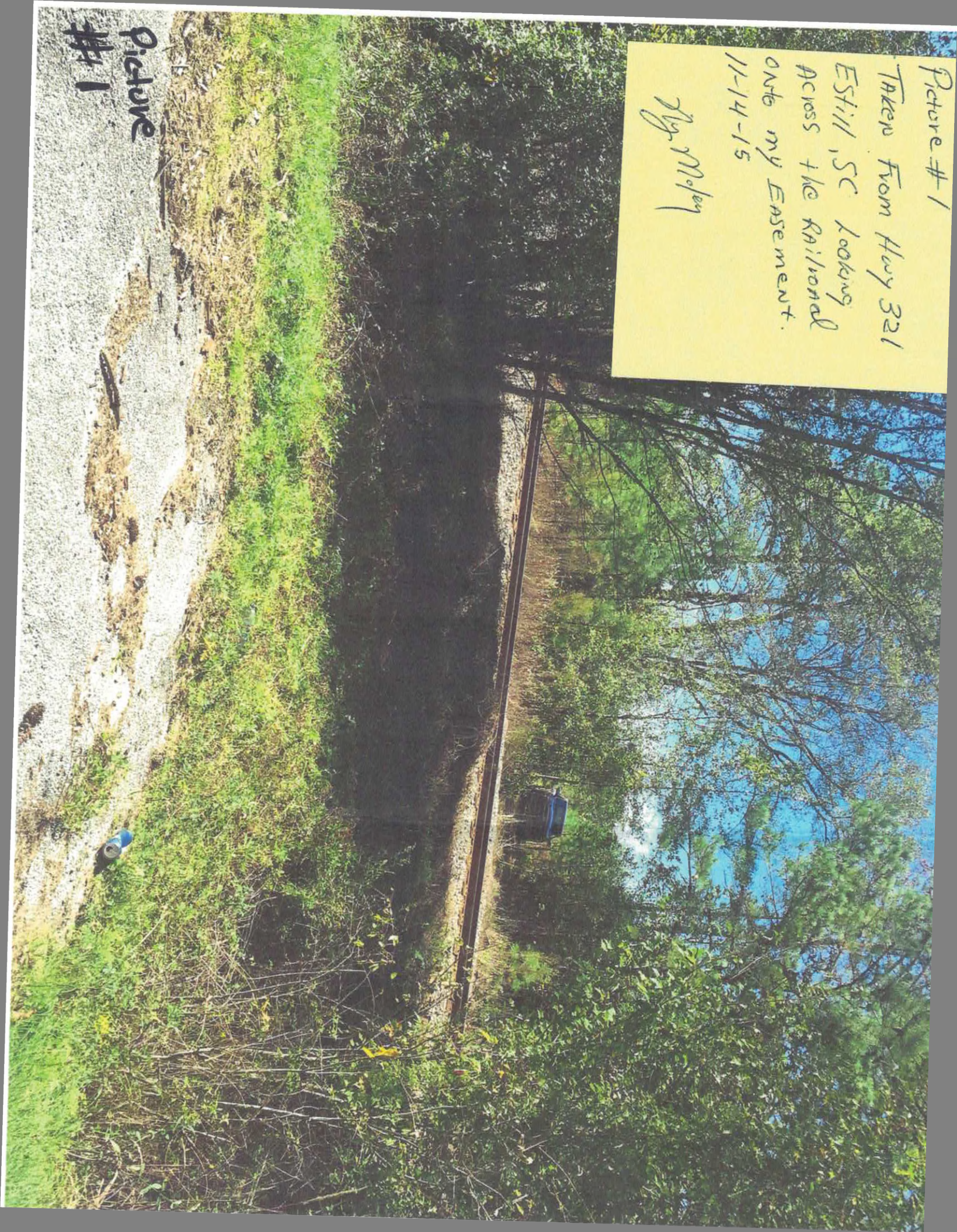

Picture # 2 was
Taken From my
Easement Looking across
CSX Railroad out U.S.
Hwy 321. Near Still
SC.
11-14-15
Robby Meyer

Picture #

2

