

MINUTES OF BUDGET AND CONTROL BOARD MEETING

MAY 10, 1967

- o -

The Budget and Control Board met in the Conference Room in the Governor's Office, in the Capitol Building, at 4:30 P. M., on Wednesday, May 10, 1967, with all members present. Mr. P. C. Smith, State Auditor and Secretary of the Board, was also present.

The following business was transacted.

1. MENTAL HEALTH COMMISSION

At the opening of the meeting Colonel John G. Morris, of the Mental Health Commission, appeared before the Board in the interest of two permanent improvement projects involving an addition to the James F. Byrnes Clinic, estimated to cost \$294,100.00, and an Infirmary and Pre-Admission Facility at Pineland, estimated to cost \$426,000.00.

The addition to the Byrnes Clinic would involve Federal and State Funds on a 2/3 Federal, 1/3 State matching ratio. The Infirmary at Pineland would be financed out of an appropriation of \$600,000.00 provided by the General Assembly in 1965 for permanent improvements at that institution.

Approval was given to the above projects as requested.

2. CLEMSON UNIVERSITY

Dr. R. C. Edwards, President, and Mr. Melford A. Wilson, Vice President, of Clemson University, appeared before the Board in the interest of the following two matters:

(1) Permanent Improvements

The Board was requested to approve construction of a High Rise Dormitory to accommodate 432 students, at an estimated cost of \$2,500,000.00, and Dormitory Facilities for married students, estimated to cost \$1,250,000.00. Both of these projects are to be financed by the issuance of Housing Revenue Bonds of Clemson.

The Board approved the construction of these two projects con-

tingent upon the submission of projected housing revenue being sufficient to finance a bond issue for that purpose.

(2) Retirement of John Robert Royal Cooper

Dr. Edwards informed the Board that Mr. John R. R. Cooper, an employee of Clemson University who is retiring May 31, 1967, has raised a question regarding the amount of prior service credit given him by the State Retirement System.

The period involved is from August 15, 1943 to January 1, 1946 during which time Mr. Cooper was on leave of absence from Clemson and was employed as Traveling Secretary for the National Council of Y.M.C.A.'s.

Authorities of the State Retirement System have taken the position that this employment was outside of that covered, or creditable, under Retirement System Laws and Regulations, and was accordingly disallowed.

A copy of a memorandum of the Personnel Office of Clemson University relating to Mr. Cooper's employment at Clemson is attached as a part of the minutes.

The Board sustained the position taken by Mr. Gresettee, of the Retirement System.

3. UNIVERSITY OF SOUTH CAROLINA

Dr. Thomas F. Jones, President, and Mr. Harold Brunton, Vice President, of the University of South Carolina, appeared before the Board requesting approval of two permanent improvement projects, (1) a Men's Residence Hall to accommodate 480 students, at an estimated cost of \$3,100,000.00, and (2) a Men's Residence Hall to accommodate 178 students, at an estimated cost of \$1,200,000.00.

Each of the above projects is to be financed by the issuance of Housing Revenue Bonds of the University.

The Board approved the projects with the understanding that projected revenue from the two facilities is sufficient to cover the bond issues necessary.

4. DEPARTMENT OF PARKS, RECREATION AND TOURISM

Mr. Dwight Holder, Chairman, and Messrs. John Tiller, Charles Lee and Robert E. Rigby, Jr., members of the Parks, Recreation and Tourism Commission, appeared before the Board for a discussion of the financing of the Department's activities for 1967-68.

It was noted that the Act creating the Commission provided for the transfer to the Commission of certain appropriations to the Development Board for 1967-68 for activities and responsibilities that are likewise to be transferred from the Development Board to the Commission on July 1 of this year. Mr. Holder indicated that the legislation providing for the transfer of funds was not clear as to precisely which appropriations to the Development Board are to be transferred.

After some discussion, the Board referred the matter to the State Auditor for a determination after conferring with both representatives of the Development Board and the Commission.

5. DEPARTMENT OF CORRECTIONS

The Board gave approval to:

(1) A request of the Department of Corrections to rent two tracts of land, involving a total of 54 acres, in the Broad River Road area near Walden Correctional Institution to be used in the Department's beef cattle operation. Annual rental costs will amount to \$710.00.

(2) A request of the Department for the Board's approval to establish a program for Clinical Pastoral Education for the benefit of ministerial students. Under the proposed plan the Department would provide a training program for 3 to 6 students for a period of approximately 6 months. During this time students would be paid \$175.00 per month.

The Board indicated no objection to the proposal but felt that Board action was not required.

Mr. MacDougall, Director of the Department, requested the Board's approval of the budgeting of \$1,800.00 per year of appropriated funds to cover

entertainment expenses. The Board declined to take action on the request at this time.

6. FORESTRY COMMISSION

In accord with legislation passed by the 1966 session of the General Assembly the Commission has purchased a tract of land near St. George, South Carolina for the establishment of a tree nursery.

The Commission at this time is requesting the Board's approval to expend \$4,000.00 to obtain a permanent easement between this tract and a nearby stream of water in order to obtain sufficient water for operation of the nursery.

The Board approved the request.

7. CIVIL CONTINGENT FUND ALLOCATIONS

The Board approved the following allocations from the Civil Contingent Fund.

(1) An allocation of \$1,000.00 to the Department of Veterans Affairs for Office Equipment.

(2) An allocation of \$1,200.00 to the Industrial Commission for Telephone and Telegraph.

8. NATIONAL GOVERNOR'S CONFERENCE

At the request of Governor McNair, the Board approved the payment of \$5,000.00 to the Office of the National Governor's Conference as South Carolina's share of operating requirements for 1967-68.

9. RETIREMENT SYSTEM

Mr. Tatum Gressette, Director of the Retirement System, advised the Board that the Chief Bookkeeper of the Retirement System will retire February 1, 1968. He requested the Board to provide whatever funds may be required to employ, as soon as convenient, someone to fill this position when the present employee retires.

The Board agreed to make funds available when a suitable person can be found.

10. GENERAL SERVICES DIVISION

The following items were approved at the request of Mr. Furman McEachern, Director of the Division of General Services.

(1) Building for State Library Board - The Board gave approval to the general architectural design proposed for this building, to be located on the corner of Bull and Senate Streets.

(2) In accord with action taken at the meeting March 22, 1967, the Board executed a deed to the Federal Government for the Fort Moultrie property, in Charleston County.

(3) Additional data processing equipment to supplement the present computer system was approved for the Vocational Rehabilitation Department.

(4) A request of Charleston County authorities to construct five drainage canals through marshlands in the Folly Beach area, for mosquito control, was approved with the understanding that approval is also obtained from the Director of Commercial Fisheries and the Director of the Division of Outdoor Recreation of the Wildlife Resources Department.

No further business was considered and the meeting adjourned at 6:45 P. M.

CLEMSON UNIVERSITY

CLEMSON, SOUTH CAROLINA 29631

OFFICE OF THE VICE PRESIDENT
FOR BUSINESS AND FINANCE

Personnel

April 18, 1967

MEMORANDUM

To: Dr. R.C. Edwards

Subject: Summary of Employment Record: Mr. J.R.R. Cooper

1. The South Carolina Retirement System has established credit for Mr. Cooper from September 1, 1927, to April 5, 1942, and from August 1, 1943, to August 15, 1943. These periods of employment at Clemson University are known as "prior service" because they occurred before the establishment of the Retirement System on July 1, 1945. In addition, we have mailed to Mr. Gressette a copy of Mr. Cooper's orders to report for active military duty January 23, 1942, and his honorable discharge, dated August 10, 1943. From January 1, 1946, until the present, Mr. Cooper has credit for continuous service with Clemson, making appropriate contributions, and now plans to retire at the close of business May 31, 1967.

2. In addition to the service listed above, Mr. Cooper was authorized by President R.F. Poole on August 14, 1943, to begin a period of extended leave of absence without pay, beginning August 15, 1943, to serve as a traveling Student Secretary for the National Council of the Y.M.C.A., employed by U.S.O. to visit colleges in the Southeastern states where Army and Navy trainees were stationed, helping with the program and counseling with those men. On November 15, 1943, this period of leave of absence without pay was extended to November 15, 1944. On October 17, 1944, President Poole approved another extension of leave for this same purpose until November 1, 1945. On October 10, 1945, a third extension was approved by President Poole until November 1, 1946. However, Mr. Cooper returned to active employment with Clemson University effective January 1, 1946, enrolled in the S.C. Retirement System, and was assigned Active Register Number 18663. On the initial enrollment forms (Form 2 and Form 4), prior service from September 1, 1927, through August 15, 1943, was listed for credit and his leave to work as a U.S.O. employee as traveling Secretary for the National Council of the Y.M.C.A. was also described.

3. On September 2, 1947, Mr. J.C. Littlejohn notified Mr. Charles H. Gerald, Executive Secretary of the S.C. Retirement System, that Mr. Cooper had deposited with the college treasurer his check in the amount of \$52.80 to cover appropriate contributions for the period July 1, 1945, to December 31, 1945, and that this check would be included in the remittance of contributions from other Clemson employees.

April 18, 1967

4. On September 23, 1966, in a reply to a letter requesting estimates of retirement allowances, Mr. Tatum W. Gressette advised that the period from August 15, 1943, to January 1, 1946, when Mr. Cooper was on leave and employed by the U.S.O. as Y.M.C.A. Traveling Secretary is not creditable service, therefore the contribution which he made in September 1947 in the amount of \$52.80 would be refunded to him. Mr. Gressette was requested not to make this refund but to keep the period which he had mentioned open for further consideration until Mr. Cooper could supply information concerning his work from August 15, 1943, to January 1, 1946. After supporting documents were submitted on April 4, 1967, Mr. Gressette advised Mr. Cooper that the service with the National Council of the Y.M.C.A. from August 15, 1943, to January 1, 1946, is not creditable under the provisions of the Retirement law.

5. Today, Mr. Melford A. Wilson talked with Mr. Gressette by telephone, and Mr. Wilson has discussed their conversation with you. If you desire additional information, or copies of any of these documents, please let me know.

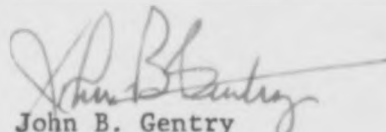
John B. Gentry
Personnel Director

JBG:jsh

cc: Mr. M.A. Wilson
Mr. Walter T. Cox

SOUTH CAROLINA RETIREMENT SYSTEM
COLUMBIA, S. C.

To the Retirement Board:

In order that I may be properly enrolled in the South Carolina Retirement System, and may receive credit for my services prior to July 1, 1945, to which I am entitled, I have carefully and truthfully filled out the following form. I understand that the full amount of deductions from my compensation will be returned to me if I leave the service without a retirement benefit or will be paid to my beneficiary or my estate if I die in active service.

(Please print name)	
1 Name Cooper, John Robert Royal	6 Present rate of compensation \$ 2720 per <div>hour day week month year</div> <div>(-) With Maintenance (X) Without Maintenance</div>
2 Home address Clemson, S.C. County Pickens	7 Present rate of maintenance allowance, if any, \$ _____ per year.
3 Employed by: Y.M.C.A.	8 Check by (X) Marital Condition <div>Single (-) Married (X) Widowed (-) Divorced (-)</div>
Institution or School Clemson College	9 Check by (X) Sex Male (X) Female (-)
Town or County Oconee	10 Race White (X) Colored (-)
4 Title as it appears on payroll Associate Secretary	9 Date of Birth of self <div>Mo. Day Year</div> Nov. 6 1901
5 Date you began your present continuous service in department, school or local unit Sept. 1927	10 Date of Birth of wife or husband <div>Mo. Day Year</div> June 21 1901

11 Record of Service Rendered Prior to July 1, 1945. (Include only service paid for.)

No prior service may be credited unless an employee was in service at any time during the five years immediately preceding July 1, 1945, and becomes a member before July 1, 1946. If you claim any prior service it should be listed below, each claim being substantiated by a "Certificate of Service Claimed (Form 4)." Use a separate line for each rate of compensation which you received between July 1, 1940, and July 1, 1945. List all prior service claimed. You must show the actual rate of compensation for the period following July 1, 1940, but you need only to check the proper columns to indicate whether your compensation was fixed by the hour, day, week, month or year for service claimed before that date. Note that service immediately preceding July 1, 1945, should be entered on the bottom line.

Name and Address of Department or other subdivision thereof in which the Service was Rendered	Rate of Compensation (prior to last five years, merely check proper column if rate is not readily obtainable)				FROM			TO			Length of Service. (If per year give approximate number of days paid for in any year where total is less than 250 days)		
	Weekly	Monthly	Yearly	Other Per	Month	Day	Year	Month	Day	Year	Years	Months	Days
Granted leave from Clemson Aug. 15, 1943 to work as traveling secretary for the National Council of Y.M.C.A.'s visiting colleges where Army and Navy Trainees were located.													
Returned to duty at Clemson Jan. 1, 1946.													
Clemson					Sept 1	1927	JUNE 30	1940	12	10			
"			2400		July 1	1940	June 30	1941	1				
"			2400		July 1	1941	Apr. 5	1942		10	5		
Military Leave					Apr. 5	1942	Aug. 1	1943		15	25		
Clemson					Aug. 1	1943	Aug. 15	1943				15	
United Service Organization					See Above		July 1	1945					

Total all prior service. (Total each column separately. Do not convert days into months, or months into years.) **13 35 30**

Deduct service recorded above which is not creditable. (Do not fill in.)

Net total of service claimed. (Do not fill in.)

Tentative allowance. (Do not fill in.)

Allowance on prior service certificate. (Do not fill in.)

12 The above statements are true to the best of my knowledge and belief.
(Signature of Applicant) **John Robert Royal Cooper**

13	Membership Status	Group	Payroll Period	Amount Earnable	Amount Deductible
(Do not fill in)					
Entered by					
Checked by					

REVIEWED: For Department by **P. J. Tate** For Retirement System by **W. C. Smith**

(FILL OUT REVERSE SIDE)

1502

Active No. 18663

TRV Cor
B. S. S. S.
9/21/66

14. DESIGNATION OF BENEFICIARY

I, the undersigned, do hereby designate Mrs. Edith Mills Cooper whose address is
(Give name of beneficiary)

Edgewood Ave. Clemson, S.C. and whose relationship to me is
(Give address of beneficiary)

Wife as the beneficiary to whom I request the Retirement Board of the South Carolina Retirement System to pay in the event of my death before retirement on pension, the total amount of the accumulated contributions standing to my credit in the retirement system.

I hereby authorize the Retirement Board of the retirement system to make payment to the beneficiary whom I have above nominated and agree on behalf of myself and my heirs and assigns, that payment so made shall be a complete discharge of the claim and shall constitute a release of the system from any further obligation on account of the benefit. I hereby direct that, should I survive the before-mentioned beneficiary, the amount which otherwise would have been payable to the beneficiary shall be paid to my estate or to such other beneficiary as I shall hereafter nominate, by written designation filed with the South Carolina Retirement System, in accordance with the rules and regulations prescribed by the Retirement Board. I reserve the right to change the beneficiary designated above.

(Signature)

John Robert Royal Cooper

STATE OF South Carolina, COUNTY OF Oconee

On this 16 day of January, 19 46, personally appeared before

me, the said named John Robert Royal Cooper

to me known and known to me to be the person described in and who executed the foregoing instrument and he (or she) acknowledged that he (or she) executed the same, and being duly sworn by me, made oath that the statements in the application are true.

(Signature of Notary Public)

Heleen Morrison

(OFFICIAL SEAL)

Notary Public.

My commission expires

at the pleasure of the Governor

AFTER YOU FILL IN THE INFORMATION DESIRED IN ITEMS 1 TO 14, YOU SHOULD
ACKNOWLEDGE YOUR SIGNATURE BEFORE A NOTARY PUBLIC.

1503

SOUTH CAROLINA RETIREMENT SYSTEM
COLUMBIA, S. C.

CERTIFICATION OF SERVICE CLAIM

Dated Feb. 8, 1946 19__

From my own knowledge

I CERTIFY THAT

John Robert Royal Cooper
(Name of Person)

WAS EMPLOYED AT

Clemson Agricultural College
(Name of Department, Bureau, Institution, Commission or School)

FROM Date 9/1/27 TO Date 3/15/43

(Military Leave from 4/5/42 to 8/1/43)

(Granted leave from Clemson August 15, 1943 to work as traveling secretary for the National Council of YMCA's visiting colleges where Army and Navy Trainees were located. Employed by United Service Organization.)

AND THAT HE RECEIVED PAY FOR SUCH SERVICES

Signed J. C. Littlejohn
Business Manager
(Official capacity or title on payroll)

PRESENT ADDRESS OF EMPLOYEE

(Number)

(Street)

Clemson
(City)

Doones
(County)

1504

AGENDA MATERIALS
AND SUPPORTING DOCUMENTS
FOR THE MEETING OF
MAY 10, 1967

AGENDA MATERIALS
AND SUPPORTING DOCUMENTS
FOR THE MEETING OF
MAY 10, 1967

AGENDA

MEETING OF BUDGET AND CONTROL BOARD

4:30 P. M., WEDNESDAY, MAY 10, 1967

CONFERENCE ROOM, GOVERNOR'S OFFICE

- o -

1. PERMANENT IMPROVEMENTS

Representatives of Clemson University, the University of South Carolina and the Mental Health Commission will appear before the Board to discuss the following permanent improvement projects.

Clemson University

Clemson proposes the construction of a High Rise Dormitory to accommodate 432 students, at an estimated cost of \$2,500,000.00, to be financed through the issuance of Dormitory Revenue Bonds.

University of South Carolina

The University proposes the construction of the following two projects.

a) A Men's Residence Hall to accommodate 480 students, with dining facilities, at an estimated cost of \$3,100,000.00.

b) A Men's Residence Hall to accommodate 178 students, with dining facilities, at an estimated cost of \$1,200,000.00.

The above two projects are to be financed by the issuance of Dormitory Revenue Bonds.

Mental Health Commission

The following two projects are proposed.

a) An addition to the diagnostic treatment center (James F. Byrnes Clinical Center) at the South Carolina State Hospital estimated to cost \$294,100.00. This project will be financed through the issuance of State Notes as authorized for permanent improvements approved by the Mental Health Commission.

b) An Infirmary and Pre-Admission Facility at Pineland estimated to cost \$426,000.00. This project will be financed out of an appropriation of

\$600,000.00 provided by the General Assembly in 1965 for permanent improvements at Pineland.

2. DEPARTMENT OF CORRECTIONS

✓ a) Land Rental

The Department requests the Board's approval to rent two tracts of land, totaling 54 acres, at an annual rental cost of \$710.00. The two tracts are located in the Broad River Road area near Walden Correctional Institution and are to be used in the Department's beef cattle program.

b) A Program for Clinical Pastoral Education

700 obj ✓ The Department has developed a rather elaborate plan for the benefit of ministerial students through a clinical program to be conducted under the supervision of its Chaplain. The plan provides for bringing in three to six ministerial students for a period of three months to a year. During this time they would be paid approximately \$175.00 per month. A detailed budget for the program indicates approximately \$8,900.00 would be required for a six months period. The cost would be defrayed out of General Operating funds of the Department.

The Board's approval of this proposed program is requested.

c) Expense Allowance for Director

over Mr. MacDougall is requesting the Board's approval of the sum of \$1,800.00 per year to be budgeted by the Department to cover expense of entertainment of guests encountered by him. A copy of his letter in this connection is attached.

3. FORESTRY COMMISSION

✓ The 1966 General Assembly appropriated \$20,000.00 to the Commission for the purchase of land for a tree nursery near St. George.

The Commission now requests the Board's approval to expend \$4,000.00 to obtain a permanent easement between this tract and a nearby stream of water in order that sufficient water may be made available for operation of the nursery.

4. CIVIL CONTINGENT FUND

The following allocations have been requested.

a) An allocation of \$1,000.00 for Office Equipment by the Department of Veterans Affairs.

b) An allocation of \$1,200.00 for Telephone and Telegraph by the Industrial Commission.

5. GOVERNOR'S OFFICE

Governor McNair has been requested by the National Governor's Conference to provide \$5,000.00 for expenses of the Conference Office for 1967-68.

6. DIRECTOR OF RETIREMENT SYSTEM

Mr. Gressette states that the Chief Bookkeeper of the Retirement System plans to retire within the next few months. He would like to discuss problems of replacement with the Board.

W. A. Keenan
SOUTH CAROLINA BUDGET AND CONTROL BOARD
DIVISION OF GENERAL SERVICES
AGENDA

Meeting of May 10, 1967.

- no*
1. Walter A. Keenan & Company offers the State the property at the North East corner of Main and Pendleton Streets for \$70,000. The lot is 69 feet on Main and about 88 feet on Pendleton. The owner desires not more than 30% paid after January 1, 1968, and the remainder over a period of several years with no interest on the balance.

It is recommended that legislation be obtained to provide for purchase of this property, with payment to be made from the Ordinary Sinking Fund.

- over*
2. Lyles, Bissett, Carlisle & Wolff and Wilbur Smith and Associates have submitted a proposal for development of a long-range development plan for the Capitol Complex. Stage 1 will provide an analysis of pressing immediate needs with recommendations for facilities which should be provided during the budgeting for fiscal year 1968-69. The cost of this stage of the study would be on a cost-plus basis, and will not exceed \$12,000.

It is recommended that funds be provided for this phase of the study.

- over*
3. Review plans for Library Board Building. *APD unknown for Audit*

- ✓*
4. Execute deed for Fort Moultrie property to United States Government in accord with action of March 22, 1967.

- ✓*
5. South Carolina Agency for Vocational Rehabilitation requests permission to rent peripheral equipment to supplement the IBM-360 computer system now in use. Monthly rental for the five pieces of equipment is approximately \$600.

It is recommended that this request be approved.

- ✓*
6. Charleston County requests permission to construct five drainage canals through the marshes on the back of Folly Beach for mosquito control.

It is recommended that the request be approved, contingent on concurrence of Director of Commercial Fisheries and Chief, Division of Outdoor Recreation.

Interim Action

1. South Carolina Department of Education has leased space at 1513 Gervais Street for operation of the Film Library. Space released in the Wallace Apartment Building to be used for other purposes by the Department.
2. Purchase and exchange of passenger vehicles:

Forestry Commission

- 1 Ford Country Sedan to replace older model.
- 3 Ford Fairlanes to replace two 1962 and one 1963 models for Radio Technicians.

Riverside School For Girls

- Plymouth Station Wagon to replace 1963 model.

South Carolina School For Girls

- Chevrolet Impala to replace 1963 Pontiac.

Employment Security Commission

- Three 10 passenger station wagons-additional vehicles for Human Resources Development Program.
- 1 Pontiac Catalina to replace 1961 Chevrolet.

University of South Carolina

- Fiat 1100-R additional vehicle for typewriter repairman.

1,635,000

3,7,000

1510-A

ACTION TAKEN
Budget and Control Board Meeting
May 10, 1967

- 1) Walter A. Keenan & Company offers the State the property at the North East corner of Main and Pendleton Streets for \$70,000. The lot is 69 feet on Main and about 88 feet on Pendleton. The owner desires not more than 30% paid after January 1, 1968, and the remainder over a period of several years with no interest on the balance.

DECLINE FOR PRESENT
PENDING STUDY

It is recommended that legislation be obtained to provide for purchase of this property with payment to be made from the Ordinary Sinking Fund.

- 2) Lyles, Bissett, Carlisle & Wolff and Wilbur Smith and Associates have submitted a proposal for development of a long-range development plan for the Capitol Complex. Stage 1 will provide an analysis of pressing immediate needs with recommendations for facilities which should be provided during the budgeting for fiscal year 1968-69. The cost of this stage of the study would be on a cost-plus basis, and will not exceed \$12,000.

PASSED OVER

It is recommended that funds be provided for this phase of the study.

- 3) Review plans for Library Board Building.

GENERAL DESIGN
APPROVED -
SUBJECT TO REVIEW
OF STATE ENGINEER
AND BOARD REVIEW
OF ~~DEEDS~~ *B/D*

- 4) Execute deed for Fort Moultrie property to United States Government in accord with action of March 22, 1967.

APPROVED

- 5) South Carolina Agency for Vocational Rehabilitation requests permission to rent peripheral equipment to supplement the IBM-360 computer system now in use. Monthly rental for the five pieces of equipment is approximately \$600.

APPROVED

It is recommended that this request be approved.

ACTION TAKEN

Budget and Control Board Meeting
May 10, 1967

Page 2

- 6) Charleston County requests permission to construct five drainage canals through the marshes on the back of Folly Beach for mosquito control.

APPROVED

It is recommended that the request be approved, contingent on concurrence of Director of Commercial Fisheries and Chief, Division of Outdoor Recreation.

INTERIM ACTION

- 1) South Carolina Department of Education has leased space at 1513 Gervais Street for operation of the Film Library. Space released in the Wallace Apartment Building to be used for other purposes by the Department.

APPROVED AND
RECEIVED AS
INFORMATION

- 2) Purchase and exchange of passenger vehicles:

Forestry Commission

- 1 Ford Country Sedan to replace older model.
- 3 Ford Fairlanes to replace two 1962 and one 1963 models for Radio Technicians.

Riverside School For Girls

Plymouth Station Wagon to replace 1963 model.

South Carolina School For Girls

Chevrolet Impala to replace 1963 Pontiac.

Employment Security Commission

Three 10 passenger station wagons-additional vehicles for Human Resources Development Program.

- 1 Pontiac Catalina to replace 1961 Chevrolet.

University of South Carolina

Fiat 1100-R additional vehicle for typewriter repairman.

1512

ACTION TAKEN

Budget and Control Board Meeting
May 10, 1967

Page 3

ADDENDA

- 1) Supplemental air conditioning equipment is needed to accommodate shift work in the Data Processing areas of the Rutledge Building. It is recommended the legislation be requested authorizing expenditure of up to \$40,000. 00 from the Ordinary Sinking Fund for this purpose.

APPROVED

B-C Prod Mtg

5/10/67

4:30

9th Conf Room

All present

M Health

Matter -

✓
✓
Caring Fund 1.5M

1) Addn' to JFB Clinic	- 294,000 (Ht. - Fund.)
2) Infirmary - Pn Adms. Fac.	- 446,000

Blumson

Edwards - Wilson

✓
✓

1) Slegel - Price	2,500,000
2) Married Students	1,250,000

Sub. to Pennine Campaign

Re: J. R. Ray College - U M C A - Since 1927

Mil. Service - WW II

Addn' time auth for WSO - 2 yrs.

Guarantee:

Not covered by law.

USC

James - Branton

W 2 - E-1'r

Rec. Comm Parks, Rec. & Tourism
Halden, Liller, Payton, Lee

153,000

255

608,000 ✓

371,110

337,000

1) Dev. Board
Kempner.

St. And. study.

2) Immediate needs -

Dev. Bd - Kempner immediately

To St. And for further action.

(3)

Gusella

Feb. 68

Acct. to arrive in ~~Sept.~~ 7,857

extent of job responsibilities.

6:45



UNIVERSITY OF SOUTH CAROLINA

COLUMBIA

29208

Senior Vice President

Office of the University

AREA CODE 803
765-3102

May 2, 1967

The Honorable P. M. Smith
State Auditor
200 Hampton Office Building
Columbia, South Carolina

Dear Mr. Smith:

We have reviewed Professor William E. Edwards' March 30, 1967, letter to the State Budget and Control Board and would have the following observations:

1. Dr. H. W. Davis, Vice President for Academic Affairs, and I feel that Professor Edwards elected to teach this Semester for the University of South Carolina and that he has a nominal load (nine teaching hours with 81 students, all undergraduates, and one student in a special research course) and should thereby have time for research or other activities which would be a part of normal activities of a faculty member.

2. The allocation of time between the University and the Department of Archeology was arranged by Professor Edwards. The University of South Carolina has advised him that it would prefer that he devote all of his time to one agency or the other.

3. If the Board feels that additional compensation is warranted, a rule-of-thumb which we apply is that a faculty member has one free day per week for outside consulting, outside research, etc. This formula could be used in ascertaining his four months' salary from the Department of Archeology.

If we can be of further assistance, kindly let us know.

Sincerely yours,

William H. Patterson



UNIVERSITY OF SOUTH CAROLINA

COLUMBIA

29208

Senior Vice President

~~OFFICE OF THE UNIVERSITY~~

AREA CODE 803

765-3102

May 2, 1967

The Honorable P. M. Smith
State Auditor
200 Hampton Office Building
Columbia, South Carolina

Dear Mr. Smith:

We have reviewed Professor William E. Edwards' March 30, 1967, letter to the State Budget and Control Board and would have the following observations:

1. Dr. H. W. Davis, Vice President for Academic Affairs, and I feel that Professor Edwards elected to teach this Semester for the University of South Carolina and that he has a nominal load (nine teaching hours with 81 students, all undergraduates, and one student in a special research course) and should thereby have time for research or other activities which would be a part of normal activities of a faculty member.

2. The allocation of time between the University and the Department of Archeology was arranged by Professor Edwards. The University of South Carolina has advised him that it would prefer that he devote all of his time to one agency or the other.

3. If the Board feels that additional compensation is warranted, a rule-of-thumb which we apply is that a faculty member has one free day per week for outside consulting, outside research, etc. This formula could be used in ascertaining his four months' salary from the Department of Archeology.

If we can be of further assistance, kindly let us know.

Sincerely yours,

William H. Patterson

STATE OF SOUTH CAROLINA
DEPARTMENT OF ARCHAEOLOGY
Columbia, S. C.

March 30, 1967

State Budget and Control Board
State of South Carolina
Columbia, South Carolina

Dear Members of the Board:

Presently I am teaching full-time and receiving from the University of South Carolina full-time salary for this work. Simultaneously, I am doing more than a full-time, forty-hour-per-week job directing the State's archaeology program -- both in administrative work and in conducting excavations. Accordingly, I request that I be permitted to draw, for the spring semester of four months only, 50 per cent of my regular salary as State Archaeologist while being paid as a professor at the University.

I understand the basis on which such extra salary is generally not approved: that it is considered that usually a man is unable to do much if anything beyond one full-time job properly. But I believe you may agree this does not mean there can be no occasional exceptions. For some years I have usually been working approximately 80 hours per week at maximum efficiency, and occasionally as much as 100 hours per week (admittedly at the cost of some inefficiency at this higher work level). My work this semester will average more than 80 hours per week. Thus the 50 per cent salary I am requesting for my work in the archaeology program is no more than half the regular rate of remuneration.

Thank you for considering this request.

Respectfully yours,

William E. Edwards
William E. Edwards
State Archaeologist

1518

	Initials	Date
Prepared By	PPH	4/24/67
Approved By		

				No. Students	Project Cost	Cost Per Student	Bldg. Height	
1	Proposed	U.S.C. Mens Residence Hall (1968)	C	178	1200000	6741 ⁰⁰	5 Bldgs. 1+2 story	1
2	Proposed	U.S.C. Mens Residence Hall (1969)	C	489	3100000	6339 ⁰⁰	9 story	2
3		U.S.C. M+N Dormitories	C	500	1863500	3757 ⁰⁰	2-7 story	3
4		U.S.C. Womens Dormitory	C	391	1804142	4614 ⁰⁰	20 stories	4
5		U.S.C. Capstone House	CC	600	4320000	7200 ⁰⁰	14 stories	5
6		State College - Womens Dormitory	-	142	660000	4648 ⁰⁰	3 stories	6
7		State College - Mens Dormitory ✓	-	140	578950	4135 ⁰⁰	3 stories	7
8		Winthrop - Womens Residence Hall	-	400	1600000	4000 ⁰⁰	8 stories	8
9		Winthrop - Womens Residence Hall #2 ✓	-	400	1700000	4250 ⁰⁰	8 stories	9
10		Clemson - Womens Residence Hall #2	-	144	720000	5000 ⁰⁰	4 stories	10
11		Clemson - Mens Dormitories 12+13	-	296	1315000	4443 ⁰⁰	4 stories	11
12		Clemson - High Rise Dormitory ✓		432	2300000	5370 ⁰⁰	11 stories	12
13								13
14								14
15								15
16								16
17								17
18								18
19								19
20								20
21								21
22								22
23								23
24								24
25								25
26								26
27								27
28								28
29								29
30								30
31								31
32								32
33								33
34								34
35								35
36								36
37								37
38								38
39								39
40								40
41								41
42								42
43								43
44								44

1518

Tom -

How do these enrollment
projections look?

RS

4/24

These projections are
consistent with my independent
projections for the University.
Max enrollment at 55% of
Full time equivalent for
1967, 1968 and 1969. Also
they are consistent with
University's long range planning
projections.

Tom



CC: President T. F. Jones

UNIVERSITY OF SOUTH CAROLINA

COLUMBIA, S. C. 29208

DIVISION OF BUSINESS AFFAIRS

April 24, 1967

State Budget and Control Board
P. O. Box 11333
Columbia, South Carolina

Attention: Mr. P. C. Smith

RE: Men's Residence Halls

Gentlemen:

Attached to this letter are two requests for approval of permanent improvement projects -- the first, a \$1,200,000, 178-bed men's residence scheduled for Fall 1968; and the second, a \$3,100,000, 489-bed men's residence scheduled for 1969.

As shown on the attached financial analysis, the University has the ability to finance both projects. The proposed borrowing also falls within presently authorized debt limits.

The University has a critical need to start both of these projects. Last Fall, all housing facilities were filled, including the newly acquired Columbia Hall and emergency housing at the Columbia Hospital. Since Capstone House will be needed for girls, the University requires more housing for men.

The following is the past and projected male housing situation with the new proposed residences.

<u>Year</u>	<u>Male Enrollment</u>	<u>No. of Beds</u>	<u>Percent</u>
1963	4,447	2,378	53.5%
1964	5,027	2,378	47.3
1965	5,858	2,680	45.7
1966	6,478	3,326	51.3
1967	7,320	3,326	45.4
1968	8,160	3,504	43.4
1969	8,770	3,993	45.4

The University believes that ideally, we should provide housing for 50% of the male students. As shown above, more than 50% was provided in 1963 and 1966 and in both years, the facilities were filled. Building the proposed 178-bed and 489-bed residences will only provide about 45% housing. This is too low but it is all that the University can do under present debt ceilings.

April 24, 1967

Both proposed residences will be located in the area between the present campus and the Rex Enright Athletic Center. The first residence has been designed by Jones and Fellers, while the second has been designed by Maynard Pearlstine in cooperation with Upshur, Riley and Bultman.

The University is ready to appear at a Board meeting, if that is felt desirable.

Respectfully submitted,

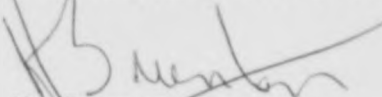

H. Brunton
Vice President - Business Affairs

HB/mf

Enclosures

STUDENT & FACULTY HOUSING REVENUE BONDS

Authorization and Balances

April 21, 1967

	<u>Issued</u>	<u>Authorized</u>	<u>To Be Outstanding</u>	<u>Highest Outstanding Debt Service</u>
Act #369 of 1953		\$ 4,000,000		
Issue 6/1/53, 3½%	\$ 375,000		\$ 180,000	\$ 21,300
Issue 6/1/54, 3%	850,000		517,000	51,450
Issue 6/1/54, 3%	50,000		28,000	2,840
Issue 6/1/55, 3%	400,000		259,000	24,150
Issue 6/1/55, 3%	50,000		28,000	2,840
Issue 6/1/56, 3%	950,000		550,000	66,500
Issue 6/1/57, 4%	750,000		568,000	51,800
Issue 6/1/58, 4%	<u>550,000</u>		<u>439,000</u>	<u>37,400</u>
Total Issued		<u>(3,975,000)</u>	\$ 2,569,000	\$ 258,280
Balance Unused		<u>\$ 25,000</u>		
Act #904 of 1960*		\$ 15,000,000		
Issue 6/1/62, 2-3/4, 3 & 3½%	\$ 2,480,000		\$ 2,381,000	\$ 122,630
Issue 6/1/62, 4½%	350,000		320,000	27,600
Issue 6/1/64, 3-3/4, 3.75 & 3.70%	3,505,000		3,505,000	211,940
Issue 6/1/66, 5½%	1,100,000		1,100,000	96,800
Pending 6/1/67	3,200,000		3,200,000	157,400
Pending 6/1/67	250,000		250,000	20,060
Pending 6/1/68	1,115,000		1,115,000	
Pending 12/1/68	<u>3,000,000</u>		<u>3,000,000</u>	<u>129,800</u>
Total		<u>(\$15,000,000)</u>	\$14,871,000	\$ 1,024,510
Balance Unused		<u>0</u>		

Debt Service Requirement

Highest Outstanding Debt Service	\$ 1,024,510
Add: 25% Margin Requirement	<u>256,130</u>
Total 125% Margin	\$ 1,280,640
Housing Fees Collected 1965-66	<u>1,582,105</u>
Balance above Margin	<u>\$ 301,465</u>

*Amended 1964 (H-2434); 1965 (H-1640); 1966 (H-2120)

BAD:cr



ELLIS C. MacDOUGALL, Director
Department of Corrections

South Carolina
Department of Corrections
P. O. BOX 766

Columbia, S. C. 29202

March 31, 1967

BOARD OF CORRECTIONS
RICHARD A. PALMER - Chairman
Florence
THOMAS P. STONEY - Vice-Chairman
Charleston
NORMAN KIRKLAND - Secretary
Bamberg
GOV. ROBERT E. McNAIR
Columbia
T.K. McDONALD
Winnsboro
EUGENE E. STONE, III
Greenville
W.M. CROMLEY, JR.
Saluda, S.C.

Mr. P. C. Smith
State Auditor
P. O. Box 11333
Columbia, South Carolina

Dear Mr. Smith:

Approval of the Budget and Control Board is respectfully requested for the Department of Corrections to rent, on an annual basis, the following tracts of land located near Walden Correctional Institution.

<u>Owner</u>	<u>Tract #</u>	<u>Acreage</u>	<u>Amt. Per Acre</u>	<u>Total Rental Cost</u>
Mrs. Cora Lorick Irmo, S. C.	1	11	\$ 10.00	\$ 110.00
Mr. Smith Berry Ballentine, S. C.	2	43	\$ 13.70	\$ 600.00

Total Cost of both Tracts - \$ 710.00

For sometime we have been in the process of increasing our herd of beef cattle and at the present time we have in excess of 400 head. This has necessitated the conversion of considerable acreage at this farm to pasture land for grazing. As a result we are badly in need of additional acreage for corn and other vital crops. We are confident that the value of crops produced on this land will far exceed the price of rental.

As the planting season is now at hand it will be appreciated if you will advise us regarding this matter at the earliest possible date.

Respectfully submitted,

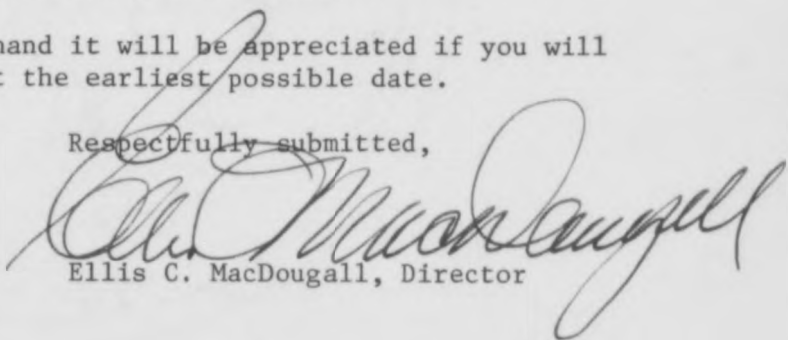
Ellis C. MacDougall, Director

EHC:rp

1524

MEMORANDUM

TO: Director Ellis C. MacDougall

FROM: E. H. Cooper, Assistant Director
Fiscal Affairs

DATE: January 25, 1967

SUBJECT: Clinical Pastorial Education Program

I have worked with Chaplain Lucas to some extent in preparing a presentation for the Budget & Control Board on the above subject. The attached explains the program in detail and is submitted for your approval and signature. Pat Smith advises that it will be necessary for the entire board to act on this matter.

E. H. Cooper

EHC:rp



ELLIS C. MacDOUGALL, Director
Department of Corrections

South Carolina
Department of Corrections

P. O. BOX 766
Columbin, S. C. 29202
January 25, 1967

BOARD OF CORRECTIONS
RICHARD A. PALMER - Chairman
Florence
THOMAS P. STONEY - Vice-Chairman
Charleston
NORMAN KIRKLAND - Secretary
Bamberg
GOV. ROBERT E. McNAIR
Columbia
T.K. McDONALD
Winnsboro
EUGENE E. STONE, III
Greenville
W.M. CROMLEY, JR.
Saluda, S.C.

Mr. P. C. Smith
State Auditor
P. O. Box 11333
Columbia, South Carolina

Dear Mr. Smith:

It will be greatly appreciated if you will present to the Budget and Control Board our request to begin a full time Clinical Pastoral Education Program at the Department of Corrections.

Our Chief Chaplain, Reverend Adlai L. Lucas, is fully qualified to conduct this program. This program will entail bringing in from three to six student-ministers, for a period of three months to one year, and they would be paid a stipend of approximately \$175.00 each per month. A proposed budget of \$8,882.00 for a six months period is submitted herewith. The funds would necessarily come from our maintenance appropriation.

In order to acquaint the Board with this program we attach an outline in which we have attempted to explain the following points:

- I. WHY DOES THE DEPARTMENT OF CORRECTIONS WANT A CLINICAL PASTORAL EDUCATION PROGRAM?
- II. TO WHAT EXTENT WILL THIS PROGRAM BENEFIT THE DEPARTMENT OF CORRECTIONS?
- III. WHAT WILL THE OBLIGATION OF THE DEPARTMENT OF CORRECTIONS BE IN REFERENCE TO THIS PROGRAM?
- IV. HOW WILL THIS PROGRAM BE FINANCED?

If any further information is needed same will be gladly furnished.

We respectfully request early action in this matter in order that we may know what course to pursue along these lines.

Respectfully submitted,

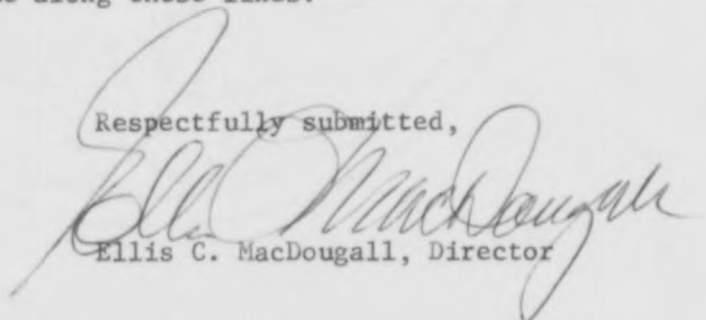
Ellis C. MacDougall, Director

ECM:lb

CLINICAL PASTORAL EDUCATION
AND
THE SOUTH CAROLINA DEPARTMENT OF CORRECTIONS

I. WHY DOES THE SOUTH CAROLINA DEPARTMENT OF CORRECTIONS WANT A
CLINICAL PASTORAL EDUCATION PROGRAM?

The South Carolina Department of Corrections exists because there is a need for its existence. People who act out their conflicts in anti-social ways must be incarcerated. If the need did not exist - that is, if there were no social offenders - the Department of Corrections would cease to be a reality.

In line with the above need-philosophy, the Department of Corrections desires a Clinical Pastoral Education Program because such a program is acutely needed. No other institution in the state can provide the training proposed.

The changing emphases of penal administration in the present generation, from custodial care to rehabilitation, make it imperative that ministers and religious workers be prepared to deal with the complex problem of criminal behavior and its affect on individuals and families.

The clergyman has traditionally been one who stands at the growing edge of life. The minister is intensively involved in the community where anti-social acts are carried out. He needs to recognize potential destructive behavior in order to make his unique contribution in the prevention area. For example, counseling with juvenile delinquents and parents. The majority of ministers in South Carolina at the current time are not adequately prepared to meet this need.

Pastors need to continue their ministry to incarcerated individuals. Pastors have a vital ministry to the family of the prisoner during the period of separation. He must be trained to adequately meet this need.

In South Carolina approximately 98% of all released social offenders return to their home community. This is a most critical time for the ex-social offender, his family, and the community. The trained pastor is in a crucial position to prepare his congregation and the larger Christian community for this inevitable occurrence.

The clergyman in South Carolina needs to be trained in the pastoral care of prisoners and their families. He is not equipped for this crisis ministry at the present time. The Department of Corrections is the only institution in this state which can provide this type of training or preparation. In fact, there is not a single correctional institution in the Southeastern United States which can accommodate this type of education.

There is in the United States today a shortage of clergymen trained as prison chaplains. In South Carolina the shortage is acute. There are relatively few institutions in the United States equipped to prepare the pastor for the prison ministry. The Department of Corrections can meet this need.

With the above in mind, it is incumbent upon the Department of Corrections to initiate and maintain a program of Clinical Pastoral Education. The Department of Corrections should take its place along with other professional institutions in preparing the ministers of South Carolina to deal with the intricate problems of anti-social behavior. The South Carolina Department of Corrections should lend itself to alleviating the shortage of trained prison chaplains.

II. TO WHAT EXTENT WILL A PROGRAM OF CLINICAL PASTORAL EDUCATION BENEFIT
THE SOUTH CAROLINA DEPARTMENT OF CORRECTIONS?

The Department of Corrections will benefit in several areas by initiating and maintaining a Program of Clinical Pastoral Education. Some of these benefits are:

(1) More and better pastoral care for residents.

It is impossible to meet the spiritual needs of our residents at the present time. Our chaplain staff is too limited. A Program of Clinical Pastoral Education will bring into the Department of Corrections qualified ministers from the free community. Approximately 50% of their time will be devoted to the pastoral care of our parishioners. This will mean student-pastors are available for individual and group counseling, Bible discussion groups, visitation, religious services, and so forth.

(2) A resource of trained prison chaplain-pastors to meet future needs of the Department of Corrections and the State of South Carolina.

It is impossible to locate trained prison chaplains in South Carolina. A Clinical Pastoral Education Program in the Department of Corrections will assure available clergy for correctional institutions. Once the program is operating, all institutions in South Carolina involved in the rehabilitation of social offenders can utilize this resource.

(3) An interpretive ministry to the free communities in South Carolina.

The history of correctional institutions reveal that religious organizations brought about the first reforms. As a result of their efforts, prisons were changed from places of torture to places of rehabilitation and reformation. Too frequently society still retains the view that a correctional institution is merely a place to get people out of the way when they have violated a law. A trained minister, with his influence and contacts, is in an excellent position to explain the purposes of modern correctional administration to the community at large in order to enlist their wholehearted cooperation in the objectives of present-day correctional procedures. A pastor who has been trained in our program will be prepared to do just this. He will do it as a natural consequence of his training. Publicity, improved public relations and communications are results of the program.

(4) An increase in the professional image of the Department of Corrections in South Carolina and in the United States.

Becoming a training organization can enhance the influence of the Department of Corrections. The Clinical Pastoral Education Program will be accredited by a national accrediting organization. This means that our training center will be advertised throughout the United States. This type of progressiveness could have a bearing on receiving future grants as well as attracting professional people to our correctional institutions for employment. As a training agency, the Department of Corrections will be actively assisting the church in the training of her clergy for a more effective ministry to people. In addition, there will be opportunities to develop working relationships with seminaries and other training centers in South Carolina and the nation.

(5) New ideas and methods.

Clergymen beginning in the training program will bring with them the desire to relate in new ways to our residents. As research will be a teaching tool in the program, new ideas and methods to deal with anti-social behavior may well result. This could mean the development of better ways to communicate to and with our parishioners; greater understanding of the adult delinquent and his behavior; and spadework in the prevention area. "An ounce of prevention is worth a pound of cure."

(6) Creating new vigor among residents and staff.

New creative minds have a constructive affect on people who live and work in a continuous environment. This will insure in some measure that we do not become self-satisfied with our approach in corrections.

(7) Give residents an opportunity to make a contribution to mankind by offering themselves as material for research and study.

This is the only contribution which some residents can make. This can result in a better understanding of social offenders and destructive behavior. In this way the Department of Corrections can gain new knowledge and insight in retraining incarcerated individuals.

The persons who will benefit the most from a training program are our inmates. The Department of Corrections exists for this purpose.

III. WHAT WILL THE OBLIGATION OF THE SOUTH CAROLINA DEPARTMENT OF CORRECTIONS BE IN REFERENCE TO A PROGRAM OF CLINICAL PASTORAL EDUCATION?

Once the Department of Corrections, through its Chaplain Supervisor, enters into contract with a theological student or active pastor, an obligation is incurred to provide Clinical Pastoral Education for the duration of the contract. Of course the contract may be set aside at any time the student does not satisfactorily complete his training. The contract may be from three months to one and/or two years depending on the interest and need of the trainee and the Department of Corrections.

In order to provide clinical training, the Department of Corrections must meet and maintain the standards of the regional and national accrediting agency. In general the following are requirements for an accredited Introductory Program of Clinical Pastoral Education:

- (1) Have at least three trainees and not more than six for each supervisor (accredited supervisor).
- (2) Be full time.
- (3) Provide trainees with an opportunity for pastoral responsibility.
- (4) Be integrated into the care and treatment functions of the institution.
- (5) Provide opportunity for interaction among the trainees.
- (6) Include weekly conferences between supervisor and trainee for direction and evaluation of pastoral work.
- (7) Provide the content needed by trainees to examine systematically their pastoral work and training experiences.
- (8) Provide means for assimilation of pastoral care insights and skills.

Another necessity on the part of the Department of Corrections is that the Clinical Pastoral Education Program must take place in an accredited training center. The Department of Corrections must meet and maintain the following standards in reference to its training center:

- (1) Have a full time Chaplain Supervisor on its staff.
- (2) Have in operation an active program of treatment and/or rehabilitation, and shall maintain an adequate teaching program.
- (3) Be receptive to groups of theological students and clergymen and make available to them staff conferences, lectures, and other learning opportunities.
- (4) Have sufficient population to permit the training group to function.
- (5) Provide adequate facilities and secretarial help for the Chaplaincy Department.
- (6) Assign duties to trainees in Clinical Pastoral Training within the institution in keeping with a chaplaincy role.

(7) Provide maintenance or its monetary equivalent for trainees on a basis comparable to similar programs for other professional groups in the institution. (This should be in the form of stipends on a basis comparable to that provided by other Clinical Pastoral Education Centers.)

(8) Cooperate with the Council in periodic reviews of its status in the training program.

(9) Have the recommendation of the Regional Accreditation Committee to the Assembly's Accreditation Committee (national organization).

The student-pastors or chaplain trainees are full time employees and should be accepted on a level with other professional employees. The trainees should be entitled to all rights and privileges as regular staff members. The compensation received by trainees is at a stipend rate and for the duration of the contracted training period.

In addition to a stipend, single students should be provided room and board on a gratis basis. Married students should receive a stipend plus one meal per working day at the expense of the Department of Corrections. Married students should provide their own housing.

The South Carolina Department of Corrections is not obligated to the students in any way beyond the contracted training period. There is no obligation to employ the minister or help him seek employment upon completion of this training.

IV. HOW WILL THE CLINICAL PASTORAL EDUCATION PROGRAM BE FINANCED?

I imagine that ultimately the necessary finances will come from appropriated funds. The minimum budget for two quarters of Introductory Clinical Pastoral Education is attached.

The operation of the program will depend on the budget which is approved. It is requested that stipends be approved in a lump sum amount so that the Department of Corrections will have freedom to select students and not have to justify the employment of each student. This will mean that, depending upon budget limitations and future budget potentialities, the Department of Corrections can enter into contract with student-pastors for projected dates to begin training. This will facilitate the planning and conducting of a continuous Clinical Pastoral Education Program.

PROPOSED BUDGET FOR TWO PROGRAMS (TWO QUARTERS) OF
INTRODUCTORY CLINICAL PASTORAL EDUCATION

<u>ITEM</u>	<u>AMOUNT</u>
SALARIES	
Stipends for 6 married students at \$175.00 per month per student for 6 months. Of the \$175.00, \$50.00 to be designated as maintenance allowance. (If the students are single, the stipends will be \$125.00 per month per student for 6 months or a total of \$4500.00.) -----	\$6300.00
MEALS	
For 6 married students for 6 months at the rate of one meal per working day. (If the students are single, the meals needed would be 3 meals per student for 6 months or a total of \$453.60.) -----	117.00
ROOMS	
For 6 single students per day for 6 months. If no rooms are available, pay the students the rate for married students. -----	????
EQUIPMENT	
6 Desks - An attempt will be made to borrow -----	
6 Typewriters - An attempt will be made to borrow -----	
1 Dictaphone (IBM) -----	400.00
1 Transcriber (IBM) -----	400.00
1 Tape Recorder (Wollensak) -----	295.00
1 Filing Cabinet, Standard, 4 Drawer, With Lock -----	75.00
1 Supply Cabinet - Made by SCDC Prison Industries -----	45.00
1 Blackboard -----	50.00
SUPPLIES	
Paper, pencils, file trays, paper clips, printing, etc. -----	250.00
LIBRARY BOOKS AND PROFESSIONAL JOURNALS -----	150.00
CONSULTANTS	
Psychiatrist, Sociologist, Criminologist. Two seminars with each consultant per quarter at \$25.00 per seminar. -----	300.00
TRAVEL	
To attend professional meetings of the Council for Clinical Training, visit seminaries, locate students. To take students to visit other institutions. -----	500.00
Approximate Total -----	\$8882.00



JOHN R. TILLER
STATE FORESTER

P. O. BOX 287
COLUMBIA, S. C. 29202

April 4, 1967

Honorable P. C. Smith, State Auditor
Wade Hampton Office Building
Columbia, S. C.

Dear Pat:

In 1956 the Forestry Commission established a tree nursery near St. George. The owner of the land would not sell outright, however, he gave a ten-year option to purchase with annual renewal payments. At the end of ten years (June 30, 1967), the Commission must purchase or the land reverts to the owner (\$20,000 purchase price established).

Certain rights to water from a stream were assumed to be in the original purchase option. The Attorney General's office drew up the purchase option. Now we find that our water rights are not included. The owner will give us a permanent easement for \$4,000 (approximately six acres of land plus access road and access to a stream). See sketch for details.

The replacement value of this property would probably exceed \$350,000 not including 20 acres of slash seed orchard which could not be moved. It is vital to our nursery operation that this tract and access to water be cleared.

We have the funds provided by the General Assembly to purchase the land (\$20,000). The Commission can purchase the easement for items marked A, B, C, D and E from Mrs. Harry Mims (same owner from whom we purchased the nursery property) for \$4,000. Permission is requested to use funds available in the Commission's operating budget to pay for this easement.

Early approval is respectfully requested since this transaction must be completed by June 30, 1967.

Very truly yours,

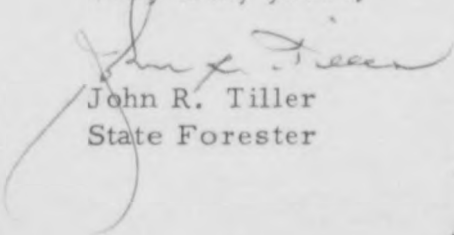
John R. Tiller
State Forester

JRT:mbs
Attachment

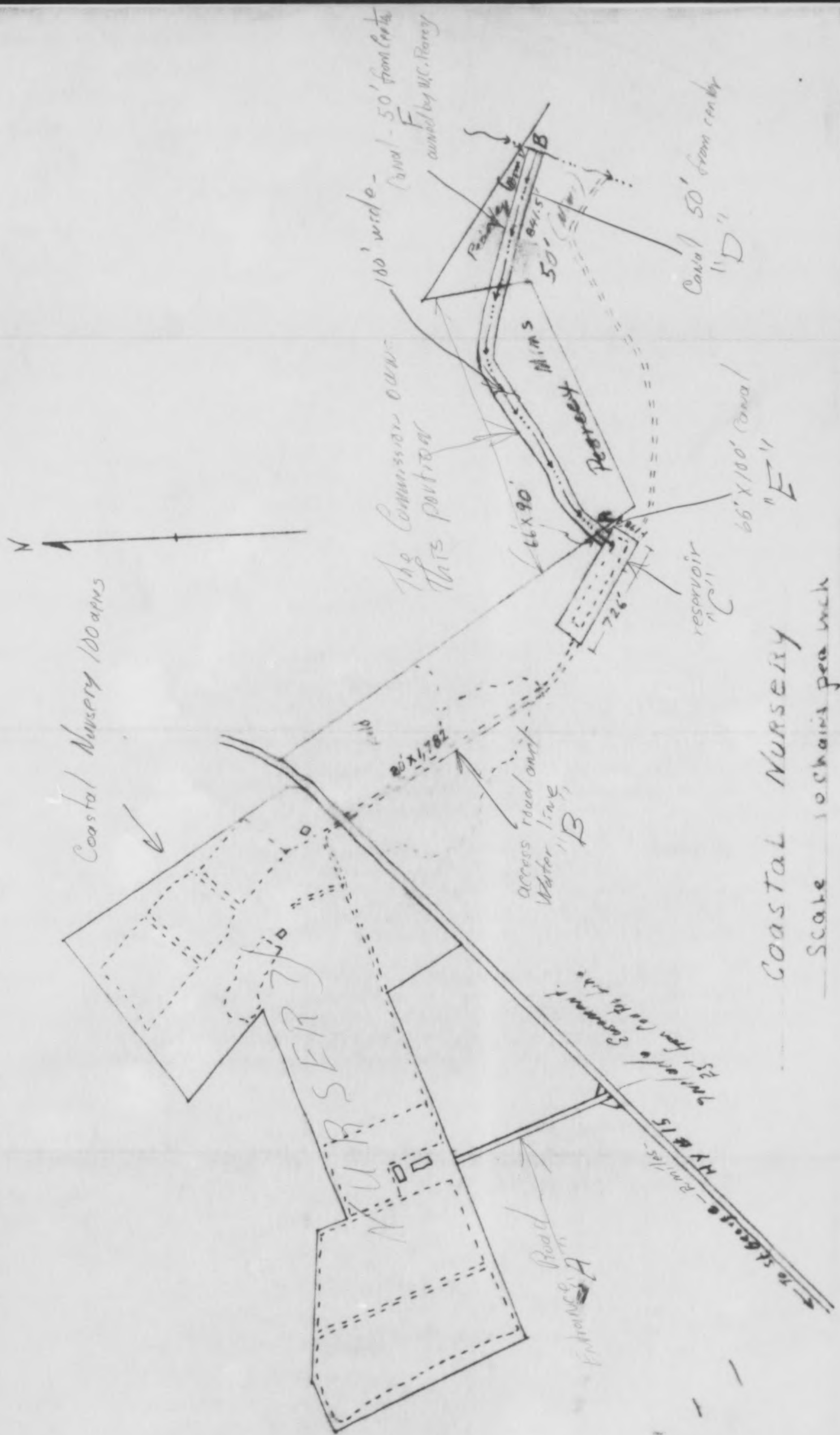

4/76

CC7

Story to Still

Ofc. Equip. - 1,000

[Rev from Mangum]

The South Carolina Industrial Commission

ADMINISTERING THE WORKMEN'S COMPENSATION ACT

1429 SENATE STREET



	PHONE
PAUL M. MACMILLAN, JR. CHAIRMAN	758-3120
LOUISE B. WIDEMAN	758-2393
JAMES J. REID	758-3348
T. M. NELSON	758-3498
J. DAWSON ADDIS	758-2134
HOLMES C. DREHER	758-2282

LEONARD E. DRUMMOND
ADMINISTRATIVE ASSISTANT
PHONE 758-3251

Columbia, S. C. 29201

April 4, 1967

Mr. Patrick Smith
State Auditor
Wade Hampton Office Building
Columbia, South Carolina

Dear "Pat":

We do not want to be left out of the Deficiency Bill for this year, so I am writing you early.

As you will recall, we had some lengthy discussions in regards to our Telegraph and Telephone appropriation. In fact, I was unable to get any additional funds even though our request was justified. Mr. Rhodes didn't see it that way.

We now have \$189.71 left in our appropriation. Our telephone bill has been running about \$475.00 per month. This is a request for \$1,200.00 under the Deficiency Bill, so that we will have enough to last us until June 30, and we will be able to pay our telephone bill.

We do not have anything that we can even transfer temporarily to pay this obvious deficit.

Very truly yours,

Paul M. Macmillan, Jr.
Chairman

PMMJr/rl

The South Carolina Industrial Commission

ADMINISTERING THE WORKMEN'S COMPENSATION ACT
1429 SENATE STREET

	PHONE
PAUL M. MACMILLAN, JR. CHAIRMAN	758-3120
LOUISE B. WIDEMAN	758-2393
JAMES J. REID	758-3348
T. M. NELSON	758-3498
J. DAWSON ADDIS	758-2134
HOLMES C. DREHER	758-2282



LEONARD E. DRUMMOND
ADMINISTRATIVE ASSISTANT
PHONE 758-3251

Columbia, S. C. 29201

April 24, 1967

Mr. Patrick Smith
State Auditor
Wade Hampton Office Bldg.
Columbia, South Carolina

Dear "Pat":

I have just seen a copy of the Deficiency Bill as proposed by the Senate Finance Committee.

I was somewhat disappointed in that our request for an additional \$1,200.00 for telephone and telegraph expenses was not included. At the present time we have only about \$180.00 in this account and we have a bill for \$430.00.

I am hoping that, since this smaller amount is not included in the Deficiency Bill, you have arranged for our request to come out of the Civil and Contingent Fund.

I would appreciate an early transfer of this amount to our telephone account.

Thanks -
Very truly yours,

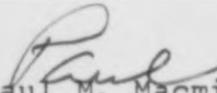
Paul M. Macmillan, Jr.
Chairman

PMMJr/rl

WILLIAM S. HALL, M.D.
State Commissioner of Mental Health

ALEXANDER G. DONALD, M.D.
Deputy Commissioner
Community Mental Health Services

JOHN G. MORRIS, JR.
Deputy Commissioner
Administrative Services



MENTAL HEALTH COMMISSION
C. M. Tucker, Jr., Chairman
John M. Fewell, M.D.
G. Werber Bryan
W. G. Edwards, Sr.
Walter H. Solomon

STATE OF SOUTH CAROLINA
DEPARTMENT OF MENTAL HEALTH

2214 BULL STREET
DRAWER 119
COLUMBIA, SOUTH CAROLINA 29202

May 5, 1967

Mr. P. C. Smith, Secretary
State Budget and Control Board
Hampton State Office Building
Columbia, South Carolina

Dear Mr. Smith:

On April 24, 1967, we were notified that the State Department of Education is discontinuing the arrangement whereby State Aid for teachers' salaries has been made available to Pineland, A State Training School and Hospital. This is being done because of a ruling that the Department of Education lacks the authority to expend State funds to supplement another agency receiving a state appropriation for the same general purpose.

We understand that the Budget and Control Board has given the Department of Education special permission to meet all committed financial responsibilities for the current fiscal year. We hereby request that this special permission be extended to cover the fiscal year 1967-68 so that this very constructive educational program can be continued at Pineland.

The ground for this request is the fact that we received notification of this projected discontinuance too late to request that the needed funds to continue the program be included in Pineland's appropriation for 1967-68. The amount involved is \$17,892 for the current fiscal year (the supplement for five teachers). During 1967-68 the total will be somewhat larger in order to provide for pay increases granted teachers. Pineland cannot afford to absorb a budgetary item of this magnitude.

If this requested extension is granted, the program can continue without interruption and this item can be included in Pineland's budget request for fiscal 1968-69.

Another reason for the discontinuance of said funds to support the educational program at Pineland was because of the ruling by the Attorney General's office stating that because of the fact that Pineland was a school and not a hospital they could not be considered eligible for funds from the State Board of Education.

I wish to advise that Pineland is a school and a hospital for the handicapped children and this fact may be confirmed by the large number of nursing attendants, "92", 8 registered nurses, 3 staff physicians and the superintendent (who is also a physician).

Mr. P. C. Smith
Page 2
May 5, 1967

It is very desirable that the Attorney General's office reconsider changing the status of Pineland from that of a school to that of "a hospital". This matter will be taken up with Assistant Attorney General Goolsby in the immediate future.

If the Attorney General's ruling is adverse and the status cannot be changed to that of "a hospital" as indicated heretofore, we would appreciate favorable action by the Budget and Control Board in extending the grace period for effecting the change whereby the State Department of Education can continue its financial assistance through the fiscal year 1967-68. This extension will permit Pineland officials to include the necessary amount of funds in the next appropriation request that is submitted to the Budget and Control Board.

Sincerely,

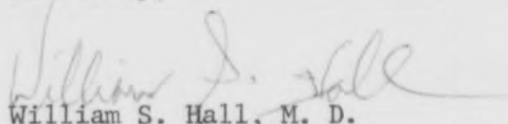

William S. Hall, M. D.
State Commissioner of Mental Health

WSH:PBP:RHC

CC: Dr. Guy Varn

Hon. Cyril Busbee

Hon. C. T. Goolsby, Jr.

E N D