

MARK	WIDTH	DEPTH	STRAIGHT BARS	BENT BARS	SIZE	NO. & SPACING	REMARKS
B1	11 1/2"	20"	2 - 7/8" ϕ	1 - 1 1/8" \square	1/2" ϕ	2 @ 8", 2 @ 10", 2 @ 12"	TYPICAL
B2	11 1/2"	20"	1 - 1" \square	1 - 1 1/8" \square	1/2" ϕ	DO	DO
B3	11 1/2"	20"	2 - 7/8" ϕ	1 - 1 1/8" \square	1/2" ϕ	DO	DO
B4	11 1/2"	20"	3 - 7/8" ϕ	—	1/2" ϕ	4 @ 8"	HOOK BARS
B5	11 1/2"	20"	2 - 7/8" ϕ	1 - 1" \square	3/8" ϕ	2 @ 8", 3 @ 12"	TYPICAL
B6	11 1/2"	20"	1 - 1" \square	1 - 1 1/8" \square	3/8" ϕ	DO	DO
B7	11 1/2"	20"	1 - 1" \square	1 - 1 1/8" \square	3/8" ϕ	DO	DO
B8	11 1/2"	22"	2 - 1" ϕ	1 - 1 1/8" \square	1/2" ϕ	4 @ 8", 4 @ 10"	DO
B9	11 1/2"	22"	2 - 7/8" ϕ	1 - 1 1/8" \square	1/2" ϕ	2 @ 8", 2 @ 10", 2 @ 15"	DO
B10	11 1/2"	22"	1 - 1 1/8" \square	1 - 1 1/8" \square	1/2" ϕ	DO	DO
B11	11 1/2"	22"	2 - 7/8" ϕ	1 - 1 1/8" \square	1/2" ϕ	DO	DO
B12	11 1/2"	18"	3 - 1" ϕ	—	3/8" ϕ	5 @ 12"	HOOK BARS
B13	11 1/2"	12"	2 - 1" ϕ	—	3/8" ϕ	2 @ 8"	DO
B14	9 1/2"	12"	2 - 3/4" ϕ	—	—	—	DO
B15	9 1/2"	16"	2 - 1" ϕ	—	3/8" ϕ	2 @ 10"	DO
B16	9 1/2"	12"	2 - 3/4" ϕ	—	—	—	DO
B17	11 1/2"	14"	2 - 7/8" ϕ	—	3/8" ϕ	2 @ 6"	DO

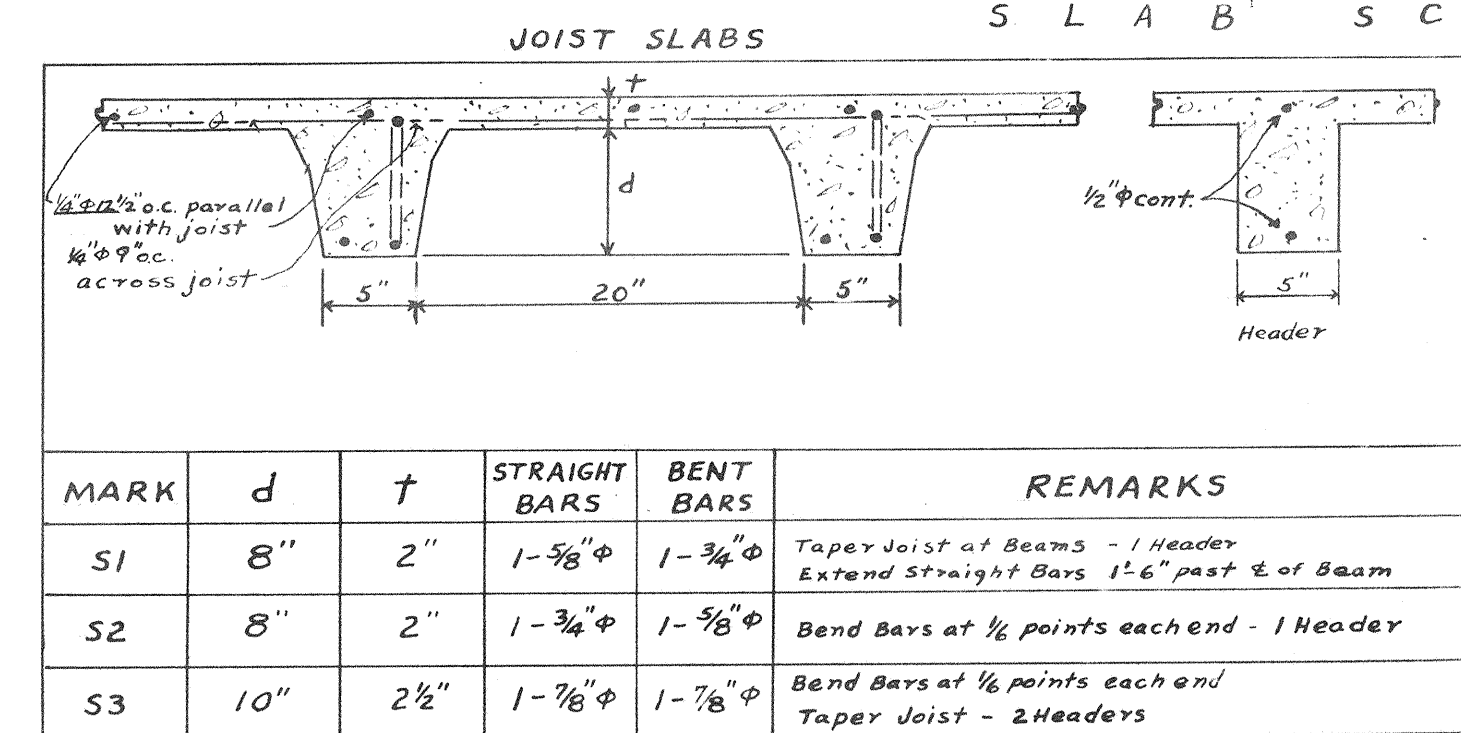

MARK	TOTAL THICKNESS	REIN. STEEL	REMARKS
S4	3 1/2"	3/8" ϕ 6" c.c.	Bend alternate bars over beam support
S5	5"	1/2" ϕ 7" c.c.	Do
S6	5"	1/2" ϕ 7" c.c.	Do
S7	5"	1/2" ϕ 7" c.c.	Do
S8	3 1/2"	3/8" ϕ 6" c.c.	Do
S9	3 1/2"	3/8" ϕ 6" c.c.	Do
S10	4"	1/2" ϕ 6" c.c.	Do
S11	3 1/2"	3/8" ϕ 6" c.c.	Do

All Plain Slabs to have temperature steel 3/8" ϕ 18" c.c. perpendicular to main reinforcing steel.

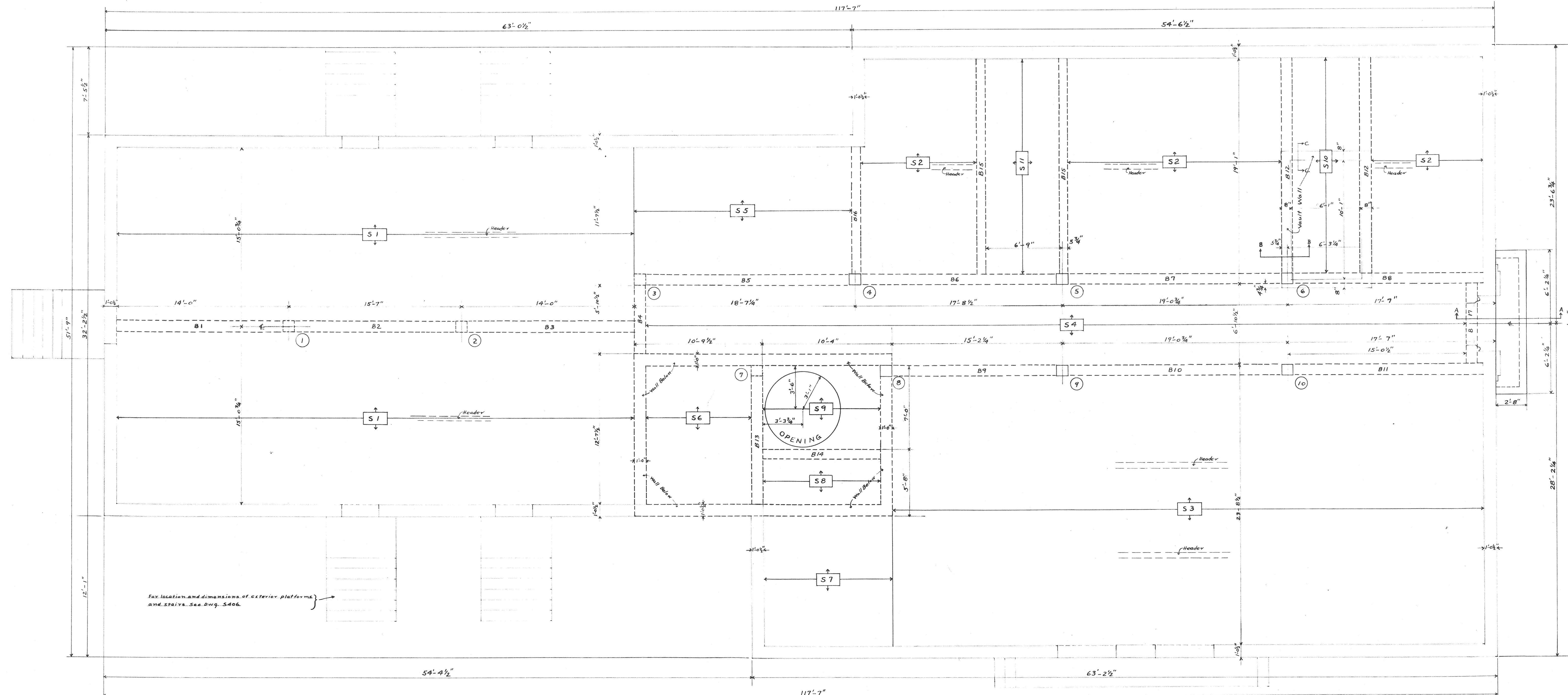
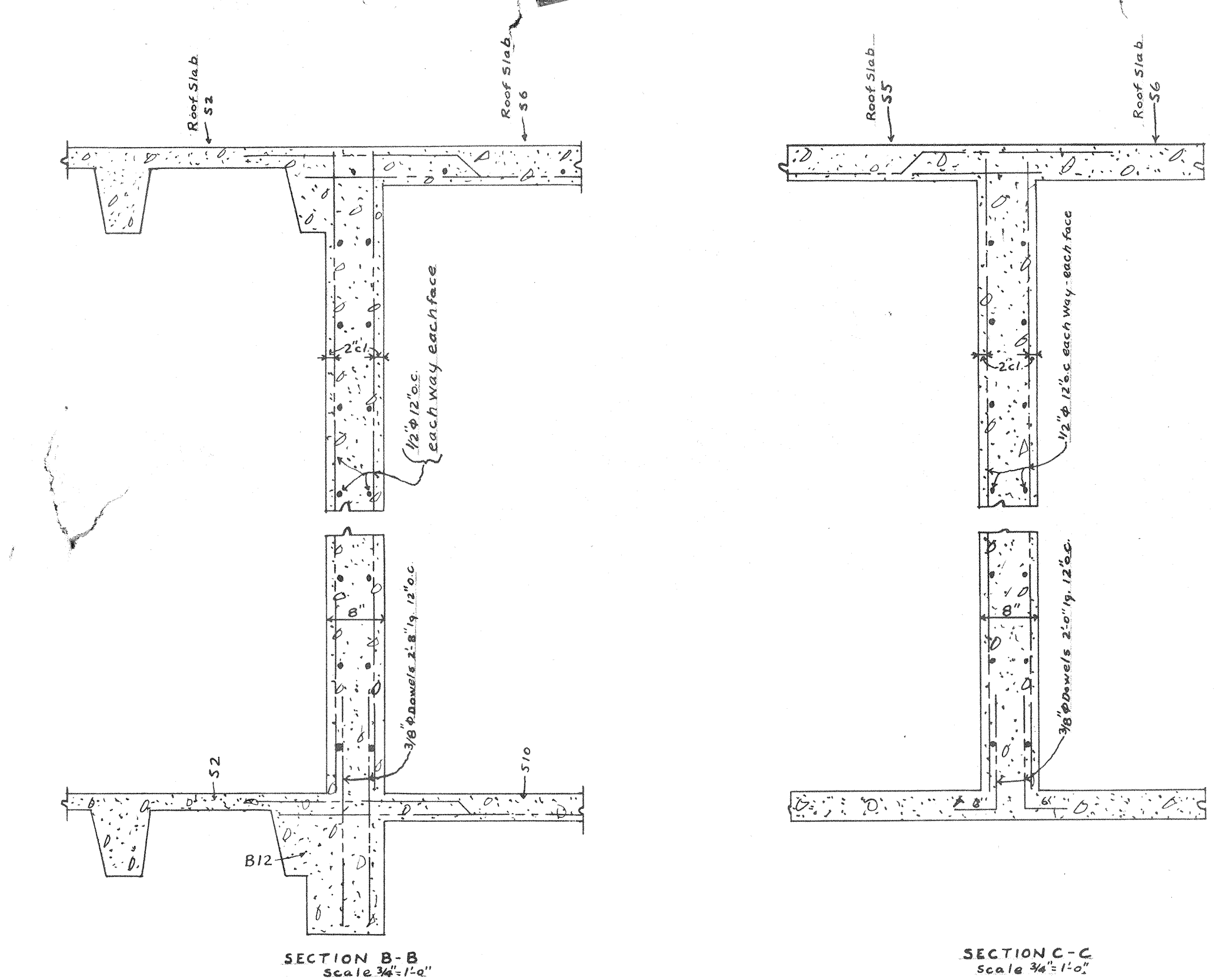

FIRST-FLOOR-PLAN

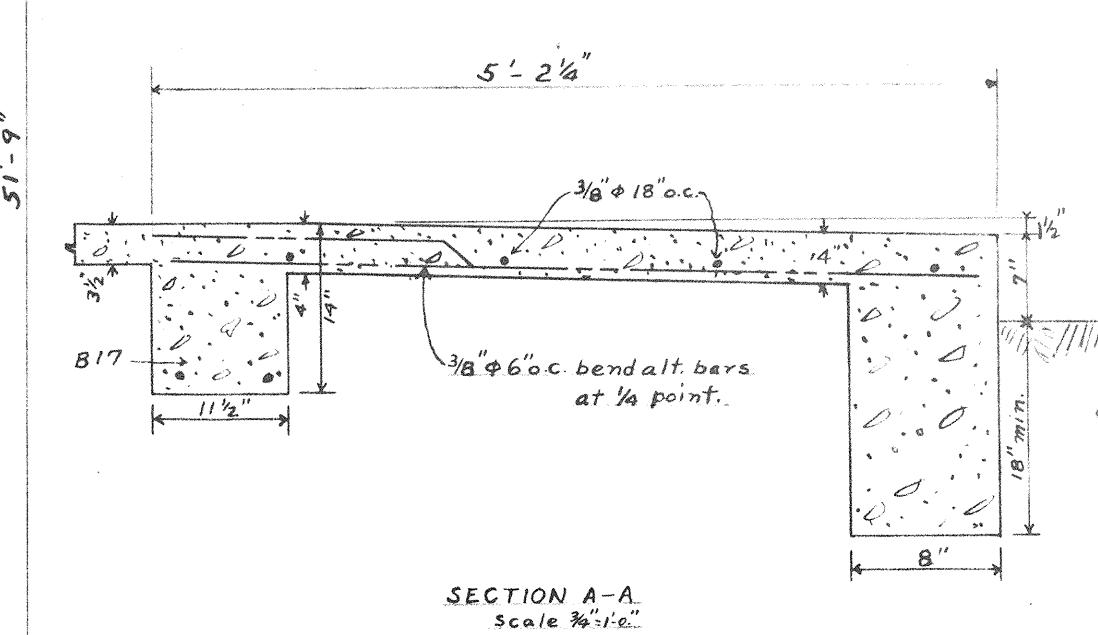

SECTION A-A

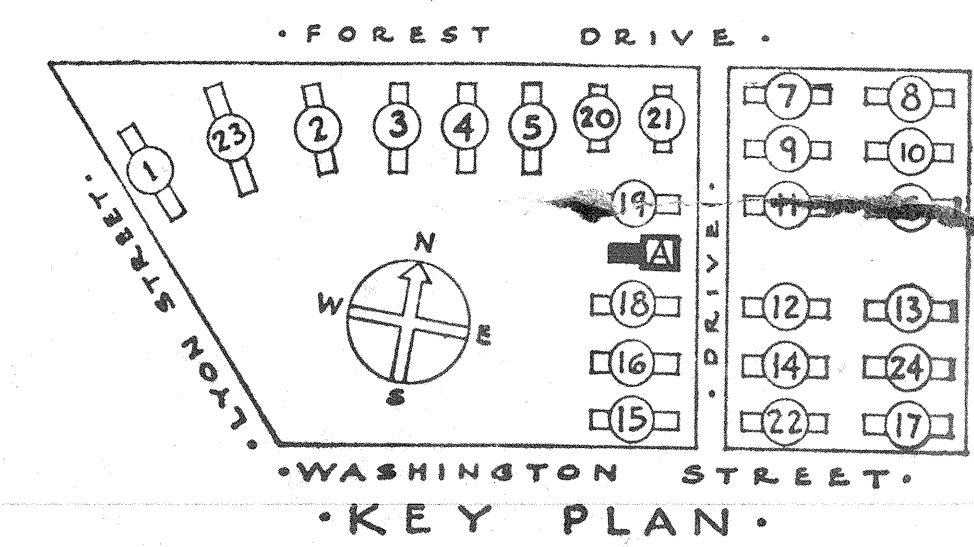

Column Number	1-2	3	4	5	6	7	8	9-10
Column Size	11 1/2" x 11 1/2"	11 1/2" x 11 1/2"	11 1/2" x 11 1/2"	11 1/2" x 11 1/2"	11 1/2" x 11 1/2"	11 1/2" x 11 1/2"	11 1/2" x 11 1/2"	11 1/2" x 11 1/2"
Vert. Steel	4 - 3/8" ϕ	4 - 3/8" ϕ	4 - 3/8" ϕ	4 - 3/8" ϕ	4 - 3/8" ϕ	4 - 3/8" ϕ	4 - 3/8" ϕ	4 - 3/8" ϕ
Column Steel	11 1/2" x 11 1/2"	11 1/2" x 11 1/2"	11 1/2" x 11 1/2"	11 1/2" x 11 1/2"	11 1/2" x 11 1/2"	11 1/2" x 11 1/2"	11 1/2" x 11 1/2"	11 1/2" x 11 1/2"
Top of Footing	4 - 3/8" ϕ	4 - 3/8" ϕ	4 - 3/8" ϕ	4 - 3/8" ϕ	4 - 3/8" ϕ	4 - 3/8" ϕ	4 - 3/8" ϕ	4 - 3/8" ϕ
Size of Footing	3'-0" x 3'-0"	3'-0" x 3'-0"	3'-6" x 3'-6"	3'-0" x 3'-9"	4'-0" x 4'-0"	4'-0" x 4'-0"	4'-0" x 4'-0"	4'-0" x 4'-0"
Total Thickness of Footing	12"	12"	13"	13"	13"	13"	13"	14"
Reinforcing Steel Each Way	8 - 3/8" ϕ	8 - 3/8" ϕ	9 - 3/8" ϕ	10 - 3/8" ϕ	11 - 3/8" ϕ	11 - 3/8" ϕ	11 - 3/8" ϕ	13 - 3/8" ϕ
Elevation Top of Footing	312'-0"	312'-0"	312'-0"	312'-0"	312'-0"	312'-0"	312'-0"	312'-0"

NOTES:
All columns to have lateral ties 1/4" ϕ 12" c.c.
For typical beam and slab steel bending details see drawing No. 3904.
All beams bearing on walls to have a minimum of 8" bearing.
Double joist to be provided under all parallel partitions where partition fall on joist slabs.
Double joist to be 10" wide and to have double amount of steel as shown for S joist.
All exterior platforms and steps to have non-slip finish as specified.

SHEET TITLE: Administration Building Floor Plan

GONZALES GARDENS
LOW RENT HOUSING PROJECT, COLUMBIA, S. C. 2-1

DEVELOPED BY:
THE HOUSING AUTHORITY OF THE CITY OF COLUMBIA, S. C.

UNDER LEASE CONTRACT WITH
UNITED STATES HOUSING AUTHORITY

CHECKED: [Signature]
DATE: 9-18-39

APPROVED BY: [Signature]
DATE: 9-18-39

ARCHITECT: [Signature]
DATE: 9-18-39

SCALE: 1/4" = 1'-0"

AS NOTED

SHEET NO. 407