

VOID

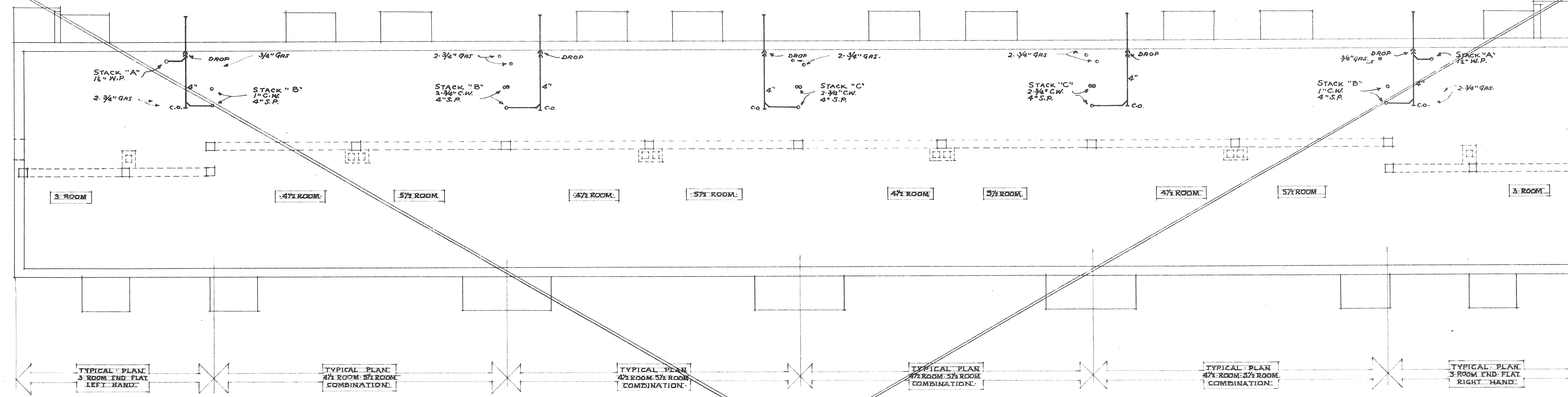

BUILDINGS

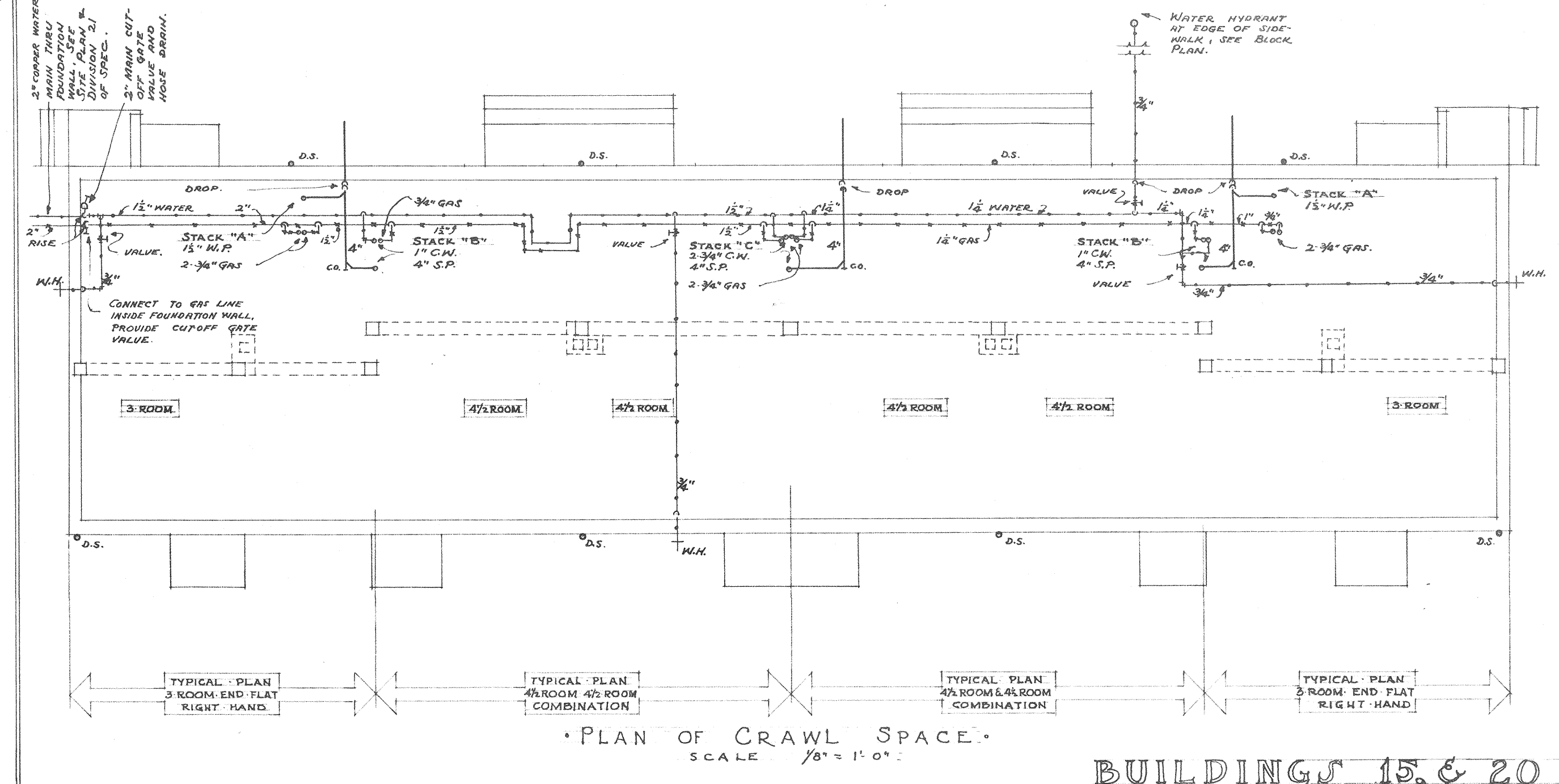

BUILDINGS 15, 16, 20, & 21

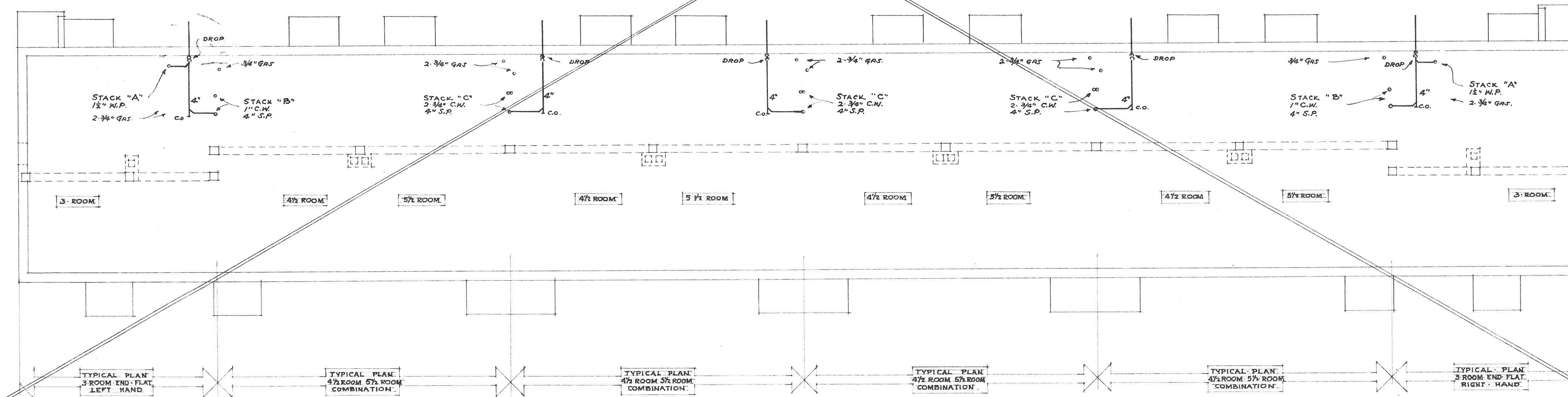

BUILDINGS

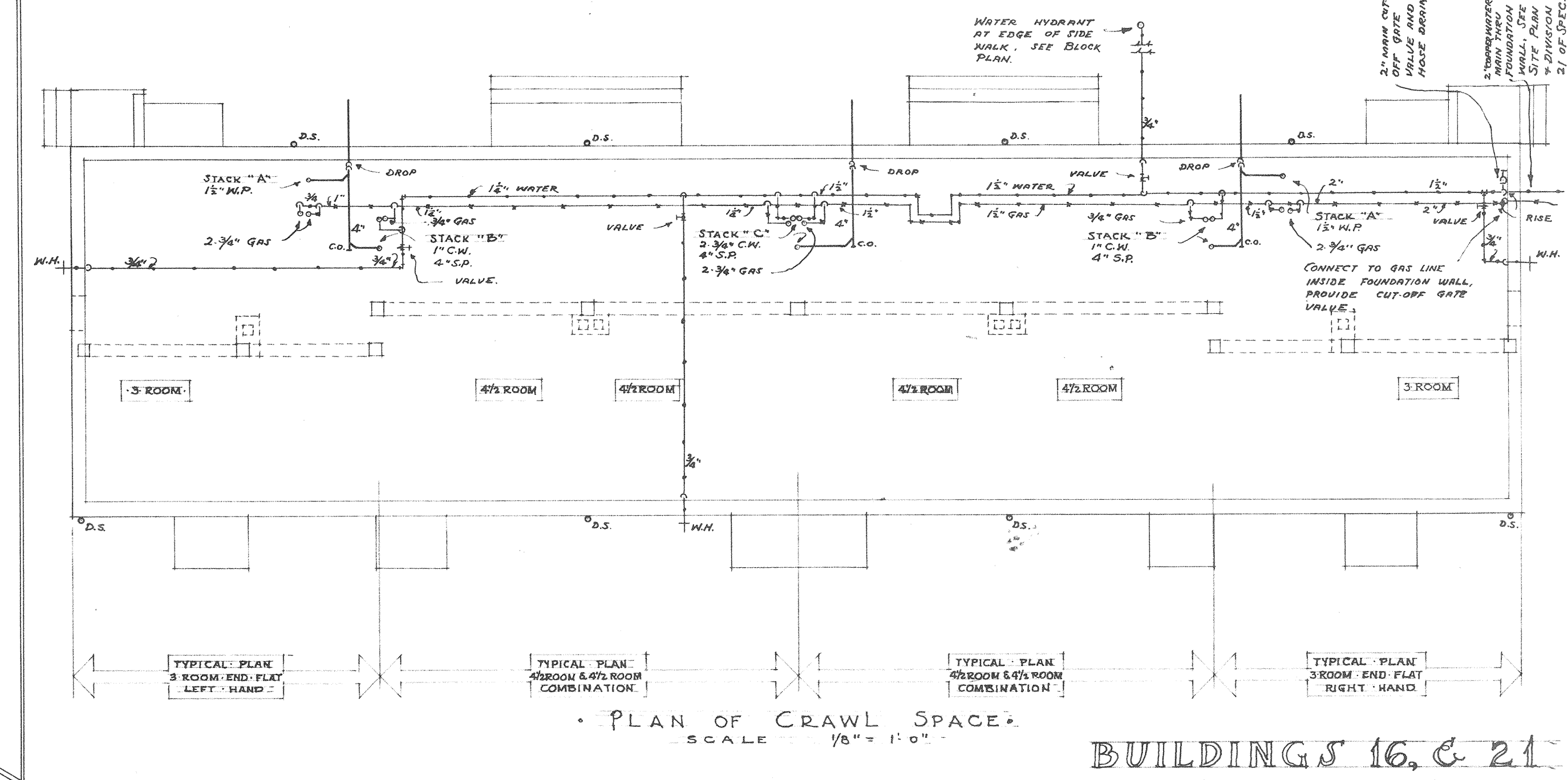

BUILDINGS 15, 16, 20, & 21

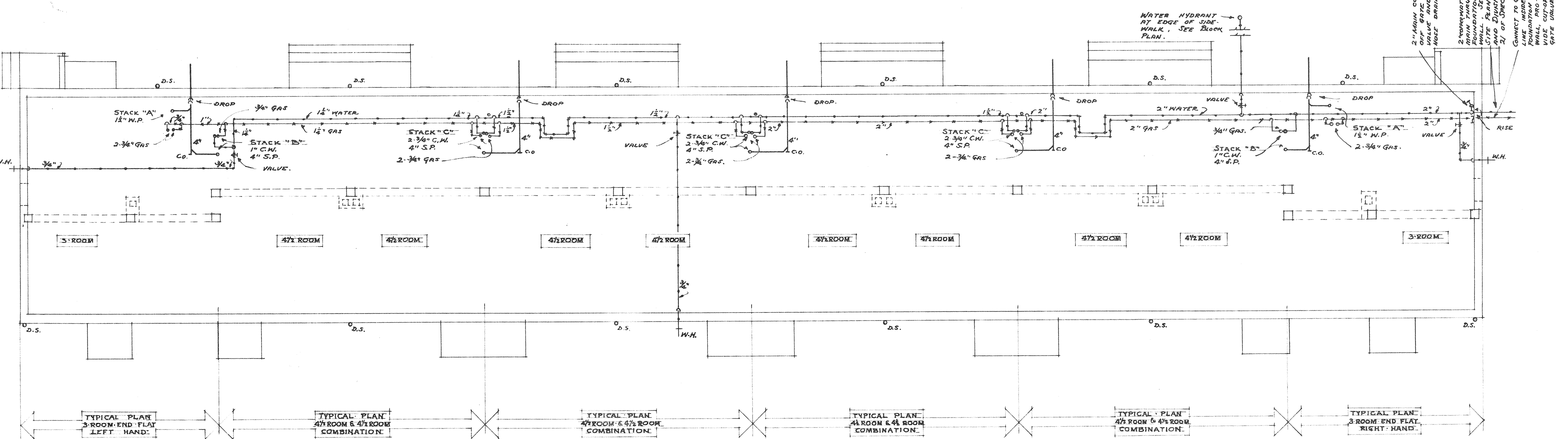

BUILDING 23

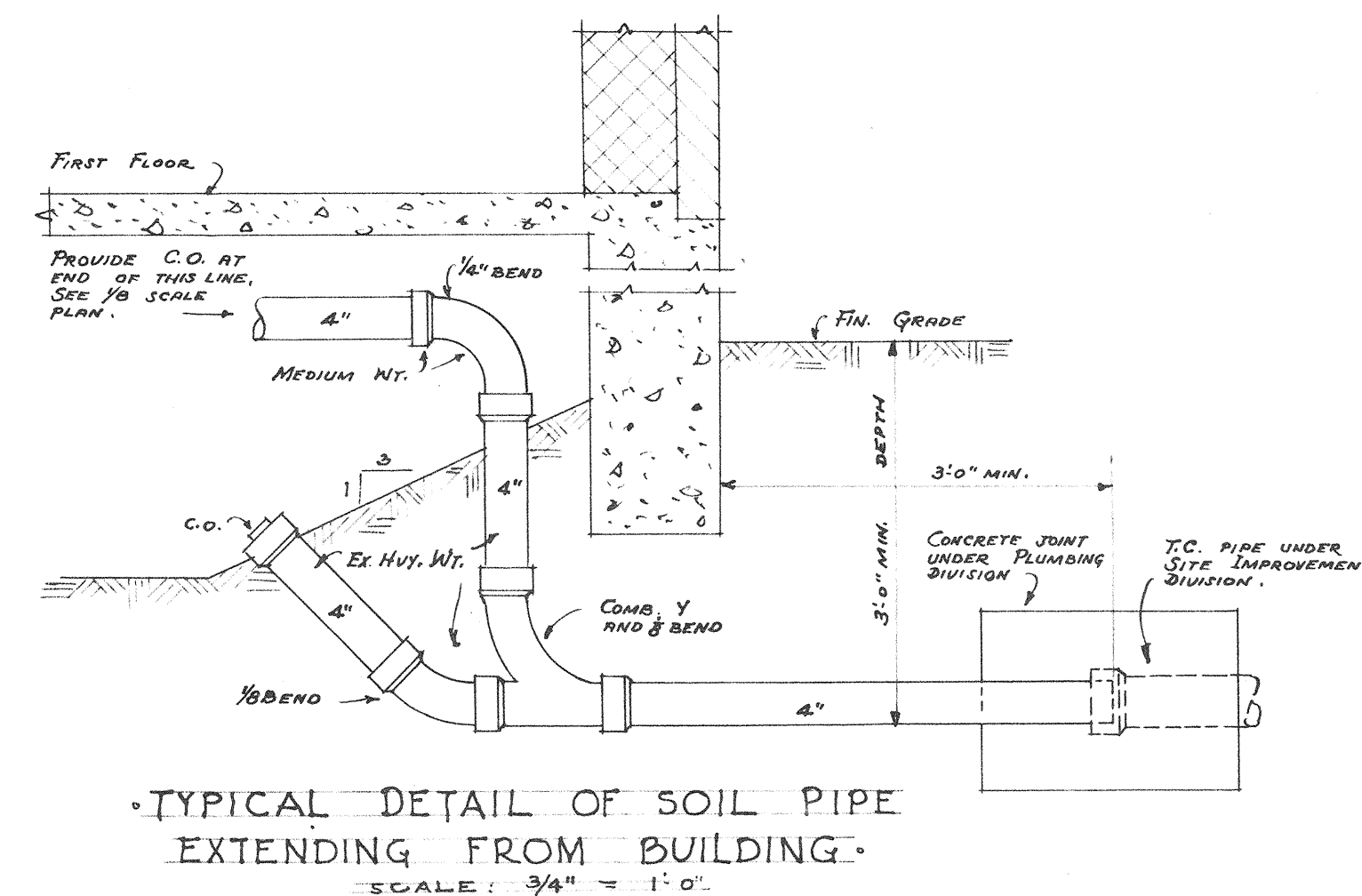

SCALE: 3/4" = 1'-0"

NOTE:
SOIL PIPES OF EXTRA HEAVY RIBS AND SPIGOT CAST IRON SHALL EXTEND 3 FEET BEYOND THE FOUNDATION WALLS OF BUILDING WHERE THEY SHALL BE CONTINUED WITH TERRAZZITA TYPE UNDER THE SITE IMPROVEMENT DIVISION OF THE SPECIFICATION. THE CONCRETE FOR THE JOINT BETWEEN CO. AND T.C. SHALL BE INCLUDED UNDER THE PLUMBING DIVISION. ELEVATION OF THE INVERT OF THE SOIL PIPES AT THE BUILDING LINE SHALL BE 3 FEET BELOW FINISHED GRADE BUT IN ALL CASES THE ELEVATION SHALL BE BELOW THE EXISTING GRADE AT THESE POINTS SO THAT PIPES WILL NOT BE LAID ON FILL.
A 2" COPPER WATER MAIN SHALL BE BROUGHT TO EACH BUILDING UNDER THE SITE IMPROVEMENT DIVISION OF THE SPECIFICATION AND SHALL EXTEND THROUGH OR UNDER THE BUILDING FOUNDATIONS WHERE IT SHALL BE PICKED UP, CUT-OFF GATE VALVE PROVIDED AND THE LINE EXTENDED IN THE CRAWL SPACE CONNECTING TO RANGES ON THE FIRST FLOOR AND RISERS TO RANGES ON THE SECOND FLOOR. GRADE GAS LINE AND MAINS TOWARD THE UNDERGROUND SERVICE MAINS.
SEE DETAIL OF TYPICAL CONNECTION TO SHEET METAL DOWN SPOUTS, AND TYPICAL DETAIL OF WATER SERVICE CONNECTION TO BUILDINGS - SHEET NS P-603.

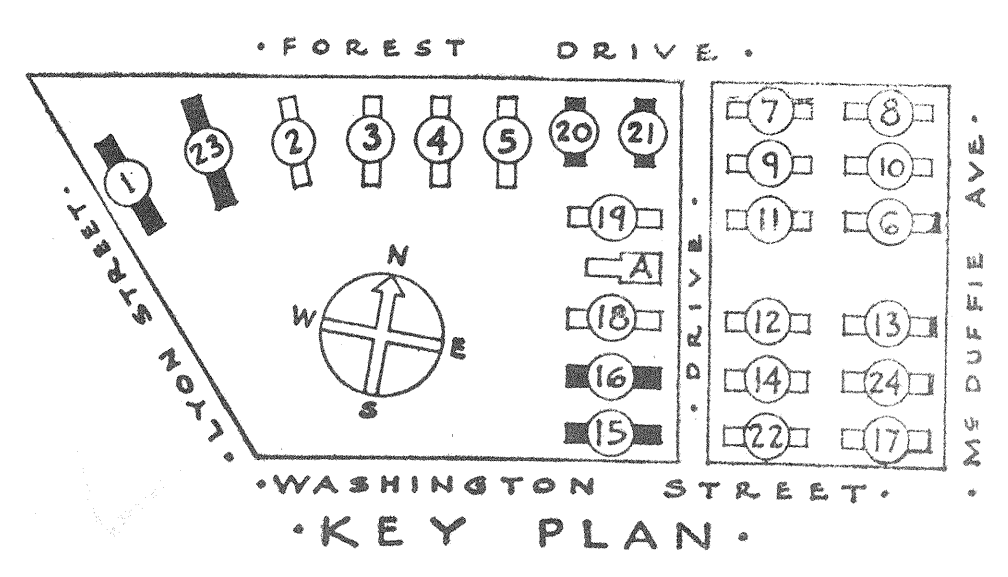

SHEET TITLE: PLAN OF PLUMBING DISTRIBUTION: BUILDINGS 1, 15, 16, 20, 21, & 23.			
GONZALES GARDENS LOW RENT HOUSING PROJECT, COLUMBIA, S. C. 2-1 THE HOUSING AUTHORITY OF THE CITY OF COLUMBIA, S. C. INDIVIDUAL CONTRACT WITH UNITED STATES HOUSING AUTHORITY			
CHECKED: K. P. T. DATE: 9-15-39	APPROVED BY: UNITED STATES HOUSING AUTHORITY ADMINISTRATOR DATE: 9-15-39	SCALE: 1/8" = 1'-0" 3/4" = 1'-0"	SHEET NO. 604
DESIGNED BY: THE HOUSING AUTHORITY OF THE CITY OF COLUMBIA, S. C. JAMES B. URBAN ARCHITECT DATE: 9-15-39		OFFICE OF JAMES POSEY CONSULTING ENGINEERS	